

ADDENDUM 3

DATE: 05/16/22

PROJECT:

'Matilda Torres High School, Toros Stadium'
Matilda Torres High School
16645 Road 26. Madera, CA 93638

OWNER:

Madera Unified School District
1902 Howard Road
Madera, CA 93637-5123

ARCHITECT:

DARDEN ARCHITECTS, INC.
Attention: Matthew Heiss
6790 N. West Avenue
Fresno, California 93711
T. (559) 448-8051
F. (559) 446-1765

DARDEN PROJECT NO. 0622.4
DSA File Nos. 10-C3
DSA APPL. NO. 02-118396

It will be the responsibility of the General Contractor to submit the information contained in this addendum to all its subcontractors and suppliers. Acknowledge receipt of this Addendum in the space provided on the Bid Form. Failure to do so may subject Bidder to disqualification.

The following additions, deletions, and revisions to the SHEETS and Project Manual are hereby made and do become a part of these Contract Documents.

INDEX OF ADDENDA TRANSMITTED HEREWITH

PROJECT MANUAL:

SPECIFICATIONS:

CHANGES TO SPECIFICATIONS AD3 -SP01 thru AD3-SP02

SHEETS:

CHANGES TO SHEETS:

ARCHITECTURAL AD3-A01 thru AD3-A05

PLUMBING N/A

MECHANICAL N/A

CIVIL N/A

ELECTRICAL N/A

STRUCTURAL N/A

LANDSCAPE N/A

ATTACHMENTS:

DOCUMENTS OR SPECIFICATIONS:

- 1. Bid RFI Log

SHEETS:

ARCHITECTURAL AD3-AX01 thru AD3-AX03

PLUMBING N/A

MECHANICAL N/A

CIVIL N/A

ELECTRICAL N/A

STRUCTURAL N/A

LANDSCAPE N/A

PROJECT MANUAL:

SPECIFICATIONS:

CHANGES TO SPECIFICATIONS:

AD3-SP01 Refer to Specification 100500 MISCELLANEOUS SPECIALTIES

1. Under section 3.3 "Schedules" add the following paragraph:

K. Batting Cage System:

1. Provide "TUFFframe Pro Outdoor Batting Cage" as manufactured by BEACON ATHLETICS.
 - a. General:
 - 1) Three support poles at each end with overhead center cable supports the cage top against sag.
 - 2) Pole thickness: 6" heavy duty support poles.
 - 3) Pole material: Schedule 40 galvanized steel pipe.
 - 4) Tensioned overhead cable.
 - 5) Cage net: #36 knotted net, vinyl-reinforced hems with grommets. Four-feet overlap at entrance. Seams shall be reinforced. Connections from net to cable shall be via grommets.
 - 6) Size and layout as noted on drawings.
 - b. Accessories:
 - 1) Vinyl Batting Cage Net Protector with Strike Zone.

AD3-SP02 Refer to Specification 100500 MISCELLANEOUS SPECIALTIES

1. Under section 3.3 "Schedules", paragraph C sub item a, delete the word "wildwood"

CHANGES TO DRAWINGS:

ARCHITECTURAL:

AD3-A01 Refer to Sheet SD/A207

1. Replace Sheet SD/A207 with attached sheet AD3-AX01

AD3-A02 Refer to Sheet SD/A212

1. Replace Sheet SD/A212 with attached sheet AD3-AX02

AD3-A03 Refer to Sheet SD/A503

1. Add detail J8 as shown on attached drawing AD3-AX03

AD3-A04 Refer to Sheet SD/A208

1. Revise detail callout at note indicating visitor side bleacher footings to read A1-B/A103

AD3-A05 Refer to Sheet G/000 TITLE SHEET, Site Development Drawing index

1. Strike out sheet SD/A204. Sheet is not applicable to project. Remove sheet SD/A304 from set. Do not bid scope indicated on sheet SD/A304

End of Addenda 3

5/16/2022 4:28:33 PM
D:\Revit Local Files\0622_4_Martin_Sl_High_School_STADIUM_V18_matthewheiss.rvt

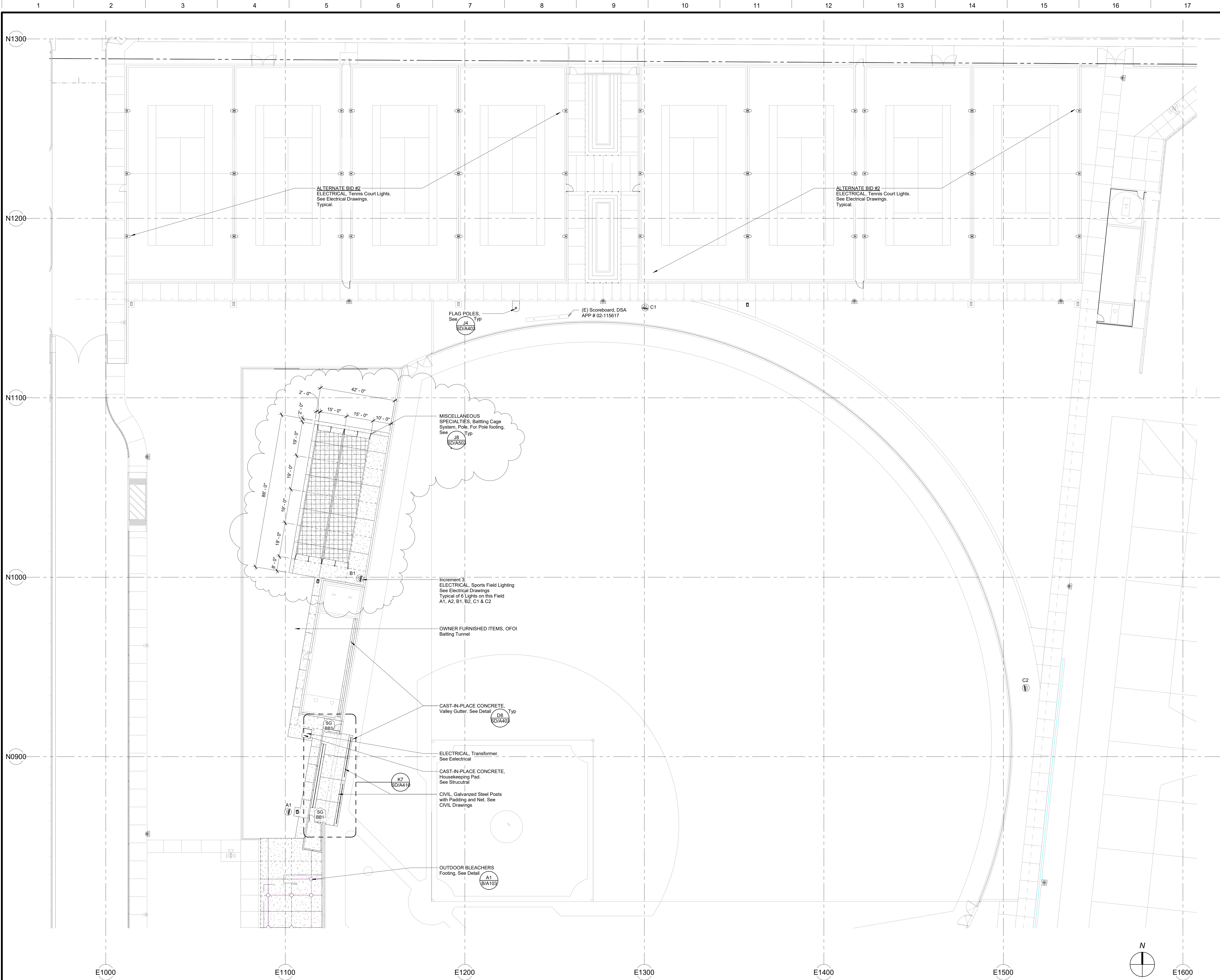

5/16/2022 4:28:35 PM
D:\Revit Local Files\0622_4_Martin_St_High_School_STADIUM_V18_matthewheiss.rvt

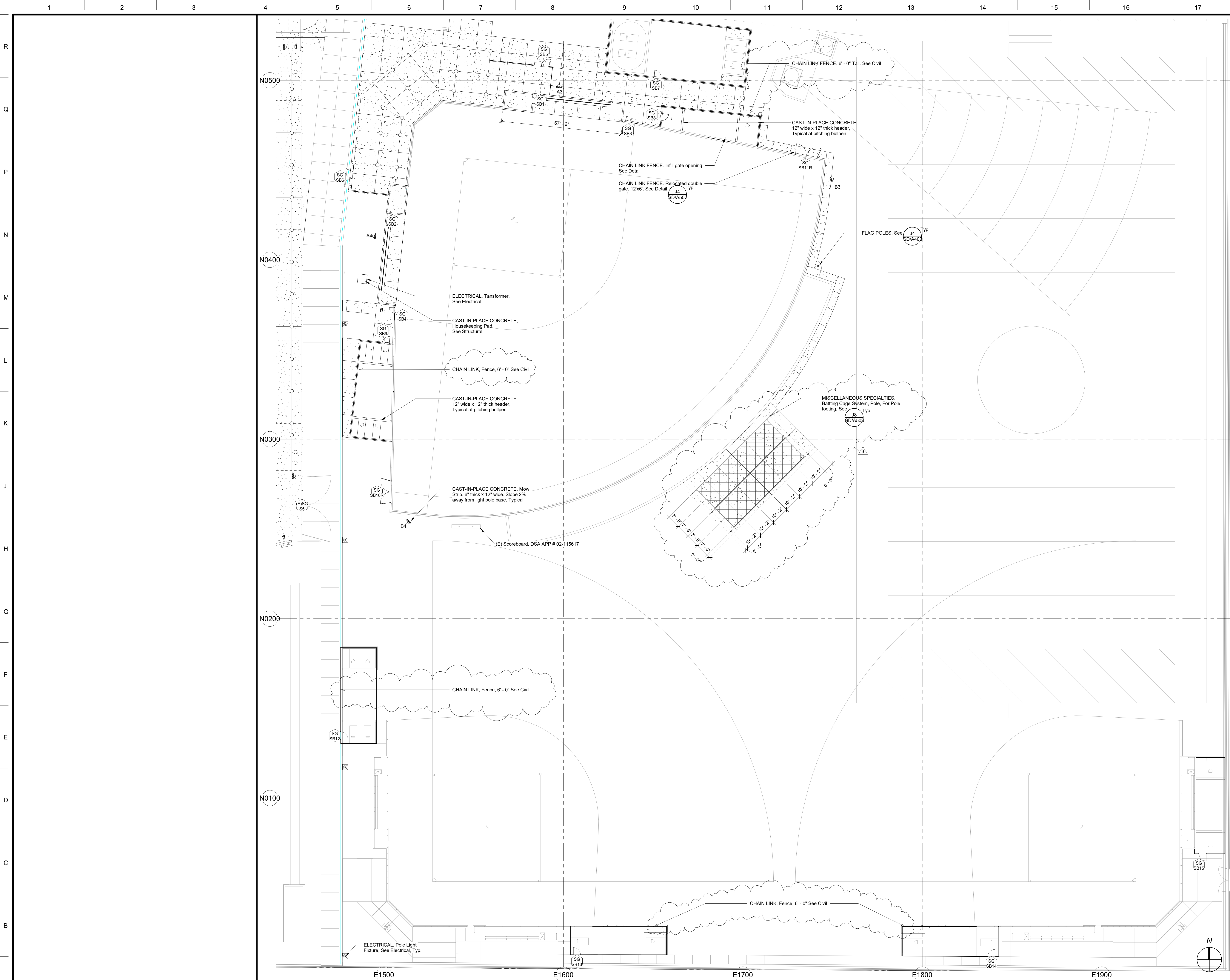

DSA File No.:

DSA Application No.:

Agency Approval

SYMBOLS

	PAVEMENT, Parking Area Seal		STORM DRAINAGE, Catch Basin or Drain Box
	CAST-IN-PLACE CONCRETE, 4" Concrete Walk over 6" 90% Compacted Fill. See Detail J4-X/A403 for Concrete Walk Details		STORM DRAINAGE, Drain Box
	CAST-IN-PLACE CONCRETE, 6" Thick, with #4 deformed bars placed at 12" on center, each way. Maintain 3' minimum clearance from earth. Placed over a 12" layer of 90% Compacted earth.		STORM DRAINAGE, Drain Inlet
	CAST-IN-PLACE CONCRETE, Dashed Lines indicate expansion joints, & solid lines indicate control joints. See Details and Specifications for additional requirements.		STORM DRAINAGE, Trench Drain
	Building Designation		PLUMBING, Fire Hydrant
	Building Outline		PLUMBING, Fire Department Connection (Siamese)
	Property Line		PLUMBING, Post Indicator Valve
	Limits of Construction (Project Area)		PLUMBING, Clean Out
	General Direction of Slope		CIVIL, Sewer Clean Out
	ELECTRICAL, Existing Light Pole		PLUMBING, Shut Off Valve
	Covered Area		ELECTRICAL & MECHANICAL, Utility Box
	ELECTRICAL, Pole Light Fixture		
	ELECTRICAL, Bollard Light Fixture		
	ELECTRICAL, Light Fixture, Directional		

ABBREVIATIONS

(E)	Existing Concrete	FF	Finish Floor	RWL	Rain Water Leader
C	Concrete	MS	Mow Strip	SD	Storm Drain
CB	Catch Basin	OC	On Center	S	Signal
CJ	Control Joint	OC	On Center	SD	Storm Drain
CO	Clean Out	FDC	Fire Dept Connection	TD	Trench Drain
DB	Drain Box	VG	Valley Gutter	Typ	Typical
DI	Drain Inlet	W	Waste	UNO	Unless Noted Otherwise
FD	Floor Drain	PL	Planter		

NOTES

- CAST-IN-PLACE CONCRETE. See symbol legend for expansion joints notes. Provide Expansion Joints where walk abouts other site vertical elements; columns, benches, building slabs.
- PLUMBING. See Plumbing Drawings
- ELECTRICAL. See Electrical Drawings
- LANDSCAPING. See Landscape and Irrigation Drawings
- Refer to CIVIL drawings for Vertical Controls and Grading

KEY PLAN - NOT TO SCALE

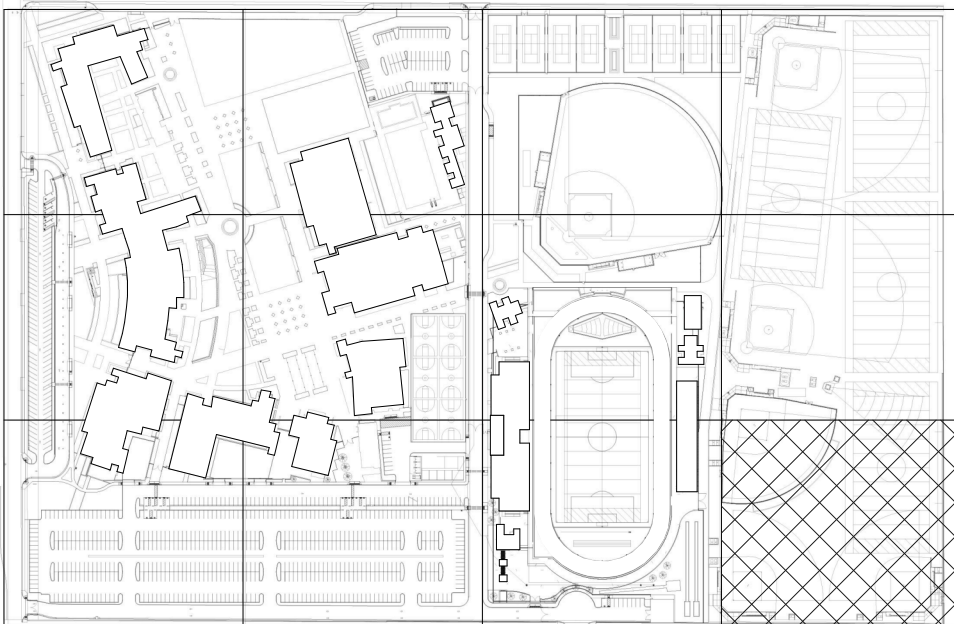

F18

No Scale

Site Plan Legend

Matilda Torres High School, Toros Stadium
Madera United School District
Madera, CA

Project

PARTIAL SITE PLAN - SOFTBALL

Drawing

**ARCHITECTURE
PLANNING
INTERIORS**
www.dardenarchitects.com
6790 N. West Ave. • Fresno, CA 93711 • T. 559.448.8051

Architect

No.	Revision/Submission	Date
0	Addenda 0	03/2022
3	addenda 3	05/16/22

Revision

Designed Designer Copyright 2020 Darden Architects

Scale: 1" = 20'-0" Drawn By: Author

Project Number: 0622.4 Checked IChecker

Date: 05/28/2021 Reviewer/Approver

SD/A212

Sheet: _____ of: _____

5/16/2022 4:29:37 PM
D:\Revit Local Files\0622_4_Martin_St_High_School_STADIUM_V18_matthewheiss.rvt

CAST IN PLACE CONCRETE, Walk.
See Site Plan

MISCELLANEOUS SPECIALTIES,
Batting Cage System, Post, Typ

CAST IN PLACE CONCRETE-
Footing, 3,500psi Concrete with W/C
Max of 0.60

EARTHWORK, Prepare for
Footing as Indicated in
'Undisturbed Soils', Typ

EARTHWORK, Compacted
Crushed aggregate

MISCELLANEOUS SPECIALTIES,
Batting Cage System Post
Condition

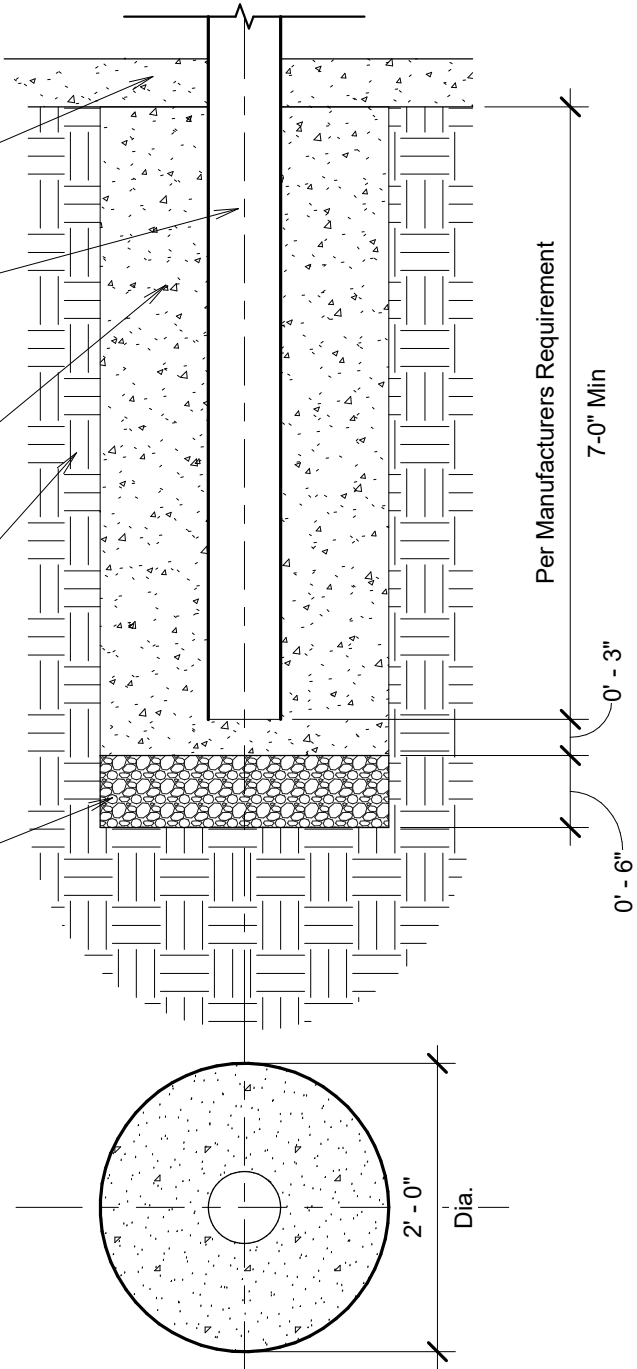

J8

3/4" = 1'-0"

Batting Cage Footing Details



ARCHITECTURE • PLANNING • INTERIORS

Edwin S. Darden Jr. AIA • Martin E. Dietz AIA CCS • Edwin C. Goodwin AIA
Robert L. Petithomme AIA • Grant E. Dodson AIA • DeDe Darnell ASID
Antonio J. Avila AIA • Michael K. Fennacy AIA • Michael J. Nelson
Sean P. Mendoza AIA • Leslie A. Rau IIDA • Martin A. Ilic
Gerardo Padron • Mathew R. Heiss AIA • Andrew A. Corral AIA

6790 N. West Avenue • Fresno, California 93711 • 559 448-8051 • Fax 559 446-1765

Project No: 0622.4

Date: 05/28/2021

Scale: 3/4" = 1'-0"

Copyright 2020 Darden Architects

Matilda Torres High School, Toros Stadium
Madera United School District
Madera, CA

AD3-AX03



RFI No.: 1

To: Matt Heiss
Company: Darden Architects
Project: Madera Torres High School Stadium Project

Date: April 22, 2022
Importance:
Discipline:

Subject: Project Increments 1-3

Response Requested By: Bernards

DRAWING & SPECIFICATION REFERENCES

Drawing Sheet / Specification	Detail / Subsection	Comments
G000		

QUESTION

1. Plan Sheet G000 indicates this project consists of (3) Increments and the bid set of documents is for Increment 1 only. Please confirm all work associated with Increments #2 & #3 are NIC and all associated costs shall not be included in the bid amount for Increment #1.

ANSWER

Construction documents include scope for all three increments. All work for all three increments as indicated in the bid docs should be included in the bid amount. Increment 2 and 3 will require the generals selected vendor to work with architect to prepare drawings for approval at DSA (similar to a deferred approval submittal)

Response Provided By:

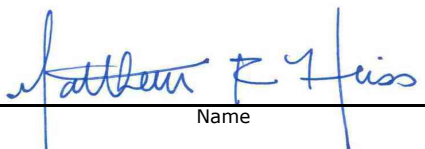
Name

Darden Architects
Company

Question Initiated By: Kenneth Yang



REQUEST FOR INFORMATION

RFI No.: 2

To: Matt Heiss
Company: Darden Architects
Project: Madera Torres High School Stadium Proj

Date: April 22, 2022
Importance:
Discipline:

Subject: Designation of Subcontractors Form

Response Requested By: Bernards

DRAWING & SPECIFICATION REFERENCES

Drawing Sheet / Specification	Detail / Subsection	Comments
-------------------------------	---------------------	----------

QUESTION

1. Please confirm City & State is acceptable for each listed Subcontractors Address on the "Designation of Subcontractors Form".
2. Please advise if the following information required on the "Designation of Subcontractors Form" can be submitted within 24 hours after the bid deadline:
 - Fax #
 - DIR Expiration Date
 - License Expiration Date

ANSWER

City and State is acceptable at time of bid. The remainder of the requested information may be submitted within 24 hours.

Response Provided By:

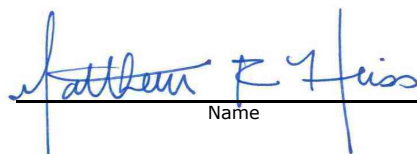
Name

DARDEN ARCHITECTS

Company

Question Initiated By: Kenneth Yang



REQUEST FOR INFORMATION

RFI No.: 3

To: Matt Heiss
Company: Darden Architects
Project: Madera Torres High School Stadium Proj

Date: April 22, 2022
Importance:
Discipline:

Subject: DVBE

Response Requested By: Bernards

DRAWING & SPECIFICATION REFERENCES

Drawing Sheet / Specification	Detail / Subsection	Comments
-------------------------------	---------------------	----------

QUESTION

1. Please confirm all DVBE related Bid Forms can be submitted within 24 hours after the bid deadline per DVBE Policy Document 00430.

ANSWER

It is acceptable for DVBE related bid forms to be turned in within 24 hours of the bid time.

Response Provided By:

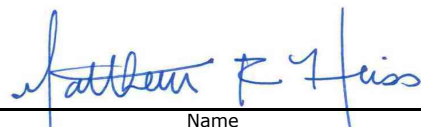
Name

DARDEN ARCHITECTS

Company

Question Initiated By: Kenneth Yang



REQUEST FOR INFORMATION

RFI No.: 4

To: Matt Heiss
Company: Darden Architects
Project: Madera Torres High School Stadium Proj

Date: April 22, 2022
Importance:
Discipline:

**Subject: Contractor & Subcontractor
Fingerprint Requirement
Certification Forms**

Response Requested By: Bernards

DRAWING & SPECIFICATION REFERENCES

Drawing Sheet / Specification	Detail / Subsection	Comments
-------------------------------	---------------------	----------

QUESTION

1. Please confirm the Contractor & Subcontractor Fingerprint Requirement Certification Forms are not required to be submitted at the time of bid.

ANSWER

The Fingerprint Requirement Certification Form is to be signed and turned in with the bid acknowledging the requirement.

Response Provided By:

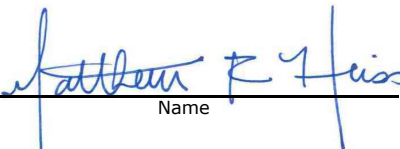
Name

DARDEN ARCHITECTS

Company

Question Initiated By: Kenneth Yang



REQUEST FOR INFORMATION

RFI No.: 5

To: Matt Heiss
Company: Darden Architects
Project: Madera Torres High School Stadium Proj

Date: April 22, 2022
Importance:
Discipline:

Subject: Builders Risk Policy

Response Requested By: Bernards

DRAWING & SPECIFICATION REFERENCES

Drawing Sheet / Specification	Detail / Subsection	Comments
-------------------------------	---------------------	----------

QUESTION

1. Please confirm the Builders Risk Policy is to be provided by the Contractor. If so, please advise if Earthquake & Flood coverage is required.

ANSWER

•The Builder's Risk Policy is to be provided by the Contractor.
See the General Conditions Article 44. Earthquake and
Flood Insurance is NOT required

Response Provided By:

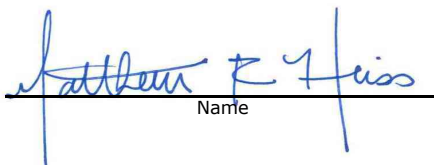
Name

DARDEN ARCHITECTS
Company

Question Initiated By: Kenneth Yang



REQUEST FOR INFORMATION

RFI No.: 6

To: Matt Heiss
Company: Darden Architects
Project: Madera Torres High School Stadium Proj

Date: April 22, 2022
Importance:
Discipline:

Subject: Temporary Power Usage

Response Requested By: Bernards

DRAWING & SPECIFICATION REFERENCES

Drawing Sheet / Specification	Detail / Subsection	Comments
-------------------------------	---------------------	----------

QUESTION

1. Please confirm all costs associated with temporary power usage (monthly billings) throughout construction are by Owner per the Special Conditions.

ANSWER

• Contractor is responsible to provide labor and materials to provide and maintain temporary power from the Schools Main Switch Board to the site. The monthly power bill (PG&E costs) will be borne by the District in accordance with Article H of the Special Conditions.

Response Provided By:

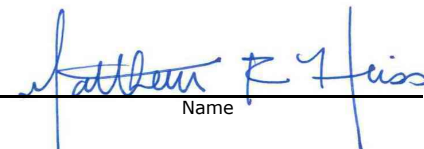
Name

DARDEN ARCHITECTS

Company

Question Initiated By: Kenneth Yang



REQUEST FOR INFORMATION

RFI No.: 7

To: Matt Heiss
Company: Darden Architects
Project: Madera Torres High School Stadium Proj

Date: April 22, 2022
Importance:
Discipline:

Subject: Allowance

Response Requested By: Bernards

DRAWING & SPECIFICATION REFERENCES

Drawing Sheet / Specification	Detail / Subsection	Comments
-------------------------------	---------------------	----------

QUESTION

1. Please consider including labor & installation within the \$850,000 Allowance for scopes of work implemented through the Allowance program.

ANSWER

•The \$850,000 allowance will be used to cover labor and material costs and will be used at the sole discretion of the District. See Special Conditions Article D for further information.

Response Provided By:

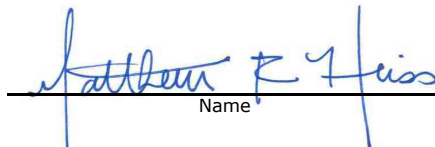
Name

DARDEN ARCHITECTS
Company

Question Initiated By: Kenneth Yang



REQUEST FOR INFORMATION

RFI No.: 8

To: Matt Heiss
Company: Darden Architects
Project: Madera Torres High School Stadium Proj

Date: April 22, 2022
Importance:
Discipline:

Subject: Project Labor Agreement

Response Requested By: Bernards

DRAWING & SPECIFICATION REFERENCES

Drawing Sheet / Specification	Detail / Subsection	Comments
-------------------------------	---------------------	----------

QUESTION

1. Please confirm there is no Project Labor Agreement.

ANSWER

There is no Project Labor Agreement for this project.

Response Provided By:

Name

Darden Architects

Company

Question Initiated By: Kenneth Yang



REQUEST FOR INFORMATION

RFI No.: 9

To: Matt Heiss
Company: Darden Architects
Project: Madera Torres High School Stadium Proj

Date: April 22, 2022
Importance:
Discipline:

Subject: OCIP

Response Requested By: Bernards

DRAWING & SPECIFICATION REFERENCES

Drawing Sheet / Specification	Detail / Subsection	Comments
-------------------------------	---------------------	----------

QUESTION

1. Please confirm there is not an OCIP.

ANSWER

•There is no OCIP program for this project.

Response Provided By:

Name

DARDEN ARCHITECTS
Company

Question Initiated By: Kenneth Yang



REQUEST FOR INFORMATION

RFI No.: 10

To: Matt Heiss
Company: Darden Architects
Project: Madera Torres High School Stadium

Date: April 25, 2022
Importance:
Discipline:

Subject: Prequal for Site Utility

Response Requested By: Bernards

DRAWING & SPECIFICATION REFERENCES

Drawing Sheet / Specification	Detail / Subsection	Comments
-------------------------------	---------------------	----------

QUESTION

1. Please advise if prequalification is required for Site Utility subcontractors.

ANSWER

•The site utility subcontractors do not need to be prequalified

Response Provided By:

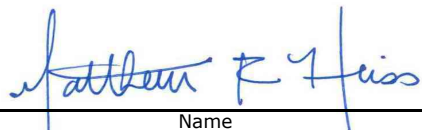
Name

DARDEN ARCHITECTS

Company

Question Initiated By: Kenneth Yang



REQUEST FOR INFORMATION

RFI No.: 11

To: Matt Heiss
Company: Darden Architects
Project: Madera Torres High School Stadium

Date: April 25, 2022
Importance:
Discipline:

Subject: Basis of Award

Response Requested By: Bernards

DRAWING & SPECIFICATION REFERENCES

Drawing Sheet / Specification	Detail / Subsection	Comments
-------------------------------	---------------------	----------

QUESTION

1. Please confirm the basis of award is the lowest grand total of the base bid plus all Alternates and the selection of Alternates will take after the Notice of Intent to Award is issued.

ANSWER

•The basis of award is the lowest grand total of the base bid, all alternates and the allowance.

Response Provided By:

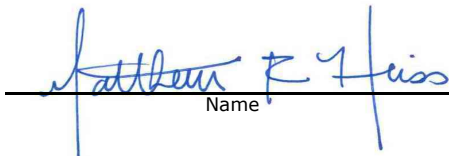
Name

DARDEN ARCHITECTS
Company

Question Initiated By: Kenneth Yang



REQUEST FOR INFORMATION

RFI No.: 12

To:
Company:
Project:

Date: April 28, 2022
Importance:
Discipline:

Subject: Food Service Reach-in Freezer

Response Requested By: Bernards

DRAWING & SPECIFICATION REFERENCES

Drawing Sheet / Specification	Detail / Subsection	Comments
114000		

QUESTION

1. Food Service Spec 1140000 notes "five (3) shelves" for item no. 03 reach-in/freezer. Please provide correct quantity

ANSWER

Food service item 03 - Reach-in-Freezer to have Three (3) Shelves.

Response Provided By:

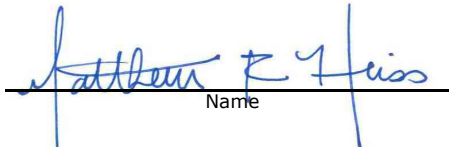
Name

DARDEN ARCHITECTS

Company

Question Initiated By: Kenneth Yang



REQUEST FOR INFORMATION

RFI No.: 13

To: Matt Heiss
Company: Darden Architects
Project: Madera Torres High School Stadium

Date: May 3, 2022
Importance:
Discipline:

Subject: Shades

Response Requested By: Bernards

DRAWING & SPECIFICATION REFERENCES

Drawing Sheet / Specification	Detail / Subsection	Comments
122413 2.3C		

QUESTION

1. Specification section 122413 2.3C states Motorized Shade System @ A113C only. A113C could not be found. Please confirm where these shades are on the project.

ANSWER

See addenda 2 for clarification.

No shades in project. Omit specification section.

Response Provided By:

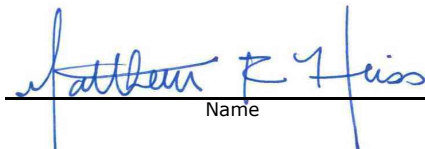
Name

Company

Question Initiated By: Kenneth Yang



REQUEST FOR INFORMATION

RFI No.: 14

To: Matt Heiss
Company: Darden Architects
Project: Madera Torres High School Stadium

Date: May 3, 2022
Importance:
Discipline:

Subject: Structural Sheet X/S552

Response Requested By: Bernards

DRAWING & SPECIFICATION REFERENCES

Drawing Sheet / Specification	Detail / Subsection	Comments
X/S552 & X/S522		

QUESTION

1. Sheet X/S552 appears to be a duplicate of sheet X/S522. Please provide the correct X/S552 sheet.

ANSWER

See addenda 2 for corrected sheet X/S552

Response Provided By:

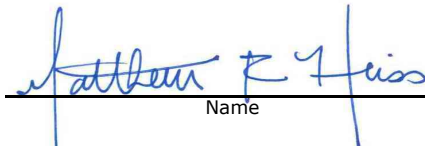
Name

Company

Question Initiated By: Kenneth Yang



REQUEST FOR INFORMATION

RFI No.: 15

To: Matt Heiss
Company: Darden Architects
Project: Madera Torres High School Stadium

Date: May 3, 2022
Importance:
Discipline:

Subject: Flag poles

Response Requested By: Bernards

DRAWING & SPECIFICATION REFERENCES

Drawing Sheet / Specification	Detail / Subsection	Comments
107500		

QUESTION

1. The flag pole specification section 107500 has two separate types/heights/mfr listed but the plans do not indicate which one is to be installed. Please clarify the correct flag pole and the the locations of each.

ANSWER

See addenda 2 for clarification of specified flag pole

Response Provided By:

Name

Company

Question Initiated By: Kenneth Yang



REQUEST FOR INFORMATION

RFI No.: 16

To: Matt Heiss
Company: Darden Architects
Project: Madera Torres High School Stadium

Date: May 5, 2022
Importance:
Discipline:

Subject: Prequalification

Response Requested By: Bernards

DRAWING & SPECIFICATION REFERENCES

Drawing Sheet / Specification	Detail / Subsection	Comments
Notice To Bidders / Add 1		

QUESTION

Please confirm that per instructions to bidders and Addendum 1 that only MEP subcontractors are required to be prequalified with the district prior to bid and that this requirement doesn't pertain to general contractors?

All Mechanical, Electrical, Plumbing and Fire Sprinkler subcontractors will be required to be pre-qualified in order to bid on this project. Please check the District's Purchasing Website to check the subcontractors that are currently prequalified with the District. The Pre-Qualification Packet is due by April 28, 2022 @ 10:00 a.m.

Please confirm that only general contractors who attended the mandatory will be considered?

A mandatory Job-Walk will be held Monday, April 25, 2022, @ 1:00 p.m. Matilda Torres High School –16645 Road 26, Madera, CA 93638 (Meet at the Project Site – located at the southeast corner of the school property.)

ANSWER

1. General Contractors do not need to be pre-qualified, only MEP and Firespirnkler Subs as indicated in the front end documents. .

2. Only Bidders present at the Mandatory Bid walk will be considered responsive. See addenda 1 attached bid walk sign in sheet

Response Provided By:

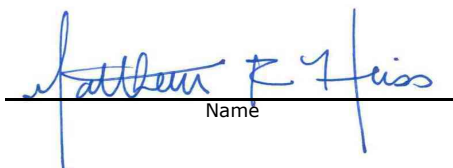
Name

Company

Question Initiated By:

Harris RFIs as of 5/10/2022

1. Please confirm that we do not need to fill out the fax number or the license classification on the bid form. Item 9 on page 5 Designation of Subcontractors only requires name, License number, DIR number, and location.

See Addenda 1

2. Is there a Division 25 on this project. It does not state "Not Used"

There are no Division 25 Specifications for this project

3. Please confirm the only Plumbing, HVAC, and Electrical Subs are to be prequalified.

See Addenda 1

4. Please confirm that Site Utility, Sheet Metal, and Fire Sprinkler Subs do not need to be prequalified.

See Addenda 1

5. Please confirm that earthquake and flood insurance is not required.

See Addenda 1

6. Page 109 in specs states that GC is to not include temp power costs in their bid. Please confirm.

See Addenda 1

7. Can you please confirm what Item 1.2.A.2 Allowance definition is describing in section 012113. What amounts of money are we to include in the contract sum and not in the allowance breakout in the bid form. This definition states labor, installation, OH, and profit to be included in Contract sum and not part of the allowance. The allowance on this project is \$850,000.

See Addenda 1

8. There is a discrepancy in the testing lab mile radius. Section 014529 states 75 miles. Page 110 "Inspection and Testing Costs By GC" states 50 miles. Which is correct?

50 miles is correct. See addenda 2 for revision clarifying requirements.

9. Plan page SD/204 is calling out the outdoor bleachers as alternate #1. Alternate description for Alternate #1 is chainlink in lieu of steel. Which is correct?

See addenda 2 for clarification. SD/A204 not applicable to project. Revise cover sheet to remove from title block. Omit sheet SD/A204 from set. Do not Bid scope indicated on sheet SD/A204. Bid alternates as indicated on title sheet and in specification ALTERNATES

10. Will there be spray on fireproofing? J11/X/A501 and 7/X/602 call it out. There is no spec for it.

Yes. See specification section 078116 – Fireproofing for requirements



Pre-Bid REQUEST FOR INFORMATION

RFI No:

1

Date:

05/10/22

Submitted to: Matt Heiss

Submitted By: David Silva

Attention: matth@dardenarchitects.com

E-mail: estimating@amgassociatesinc.com

Phone: 661-251-7401

Fax: 661-251-7405

Project:	Matilda Torres HS Stadium	Spec. Section:	
Location:		Drawing #:	B/A101, B/A102, B/A103
Sent Via		Detail:	B/A104, B/A105, SD/A507

The following information is requested:

- 1) On sheet B/A101, detail A6, the Home side bleacher foundation plan does not specify the dimensions of the footings for the bleachers. Also, what are the details for the pedestrian ramps at the sides and middle of the bleachers? Please advise.
- 2) On sheet B/A102, detail A1, the Visitors side bleacher footing plan does not specify the dimensions of the footings for the bleachers. Also, what are the details for the pedestrian ramps on both sides of the bleachers? Please advise.
- 3) On sheet B/A103, detail A1, the Baseball grandstand foundation plan does not specify the dimensions of the footings for the bleachers. It does show the diameter (24"), but not the depth. Also, what are the details for the pedestrian ramps on both sides of the bleachers? Please advise.
- 4) On sheet B/A104, detail A9, the Softball grandstand footing plan does not specify the dimensions of the footings for the bleachers. Also, what are the details for the pedestrian ramps on both sides of the bleachers? Please advise.
- 5) On sheet B/A105, there is no detail for the footings in the Aquatics complex bleachers. Are there pedestrian ramps on the sides of the bleachers? Please advise.
- 6) On sheet SD/A507 it references a CMU site wall on the East and South. Where are these walls to be taken off on the drawings?

1) See foundation plan on sheet Q/203 for home side bleacher foundation sizes. Foundation size to be verified by bleacher vendor. Ramps to be furnished by bleacher vendor. Bleacher drawings must be created by vendor and submitted with assistance of architect through DSA upon award of project.

2) foundations for visitor side bleacher to be designed by bleacher vendor. Bleacher drawings must be created by vendor and submitted with assistance of architect through DSA upon award of project.

3) See responses to questions 1) and 2)

4) See responses to questions 1) and 2)

5) Aquatics complex bleachers no longer in project. See addenda one indicating sheet B/A105 to be removed from project. Do not bid aquatics complex bleacher scope.

6) Refer to sheet SD/A206 for site walls elevated on sheet SD/A507



Pre-Bid REQUEST FOR INFORMATION

RFI No:

2

Date:

05/10/22

Submitted to: Matt Heiss

Submitted By: David Silva

Attention: matth@dardenarchitects.com

E-mail: estimating@amgassociatesinc.com

Phone: 661-251-7401

Fax: 661-251-7405

Project:

Matilda Torres HS Stadium

Spec. Section:

Location:

Drawing #:

B/A101, B/A102, B/A103

Sent Via

Detail:

B/A104, B/A105, SD/A507

The following information is requested:

Since this project is a rebid. What is the reason the bids were rejected the first time?

Response:

Project bid results exceeded the districts available budget. The project has been revised for the rebid as follows: The home side bleachers have been reduced in size, the press box tower has been reduced in size and scope, Bldg Q has been reduce din size, additional alternates have been identified



Pre-Bid REQUEST FOR INFORMATION

RFI No:

3

Date:

05/10/22

Submitted to: Matt Heiss

Submitted By: David Silva

Attention: matth@dardenarchitects.com

E-mail: estimating@amgassociatesinc.com

Phone: 661-251-7401

Fax: 661-251-7405

Project:

Matilda Torres HS Stadium

Spec. Section:

Location:

Drawing #:

Sent Via

Detail:

The following information is requested:

What is the basis of award? Base bid only?

Response:

See Addedna 1 for response



REQUEST FOR INFORMATION

RFI No.: 17

To: Matt Heiss
Company: Darden Architects
Project: Madera Torres High School Stadium

Date: May 12, 2022
Importance:
Discipline:

Subject: Gates

Response Requested By: Bernards

DRAWING & SPECIFICATION REFERENCES

Drawing Sheet / Specification	Detail / Subsection	Comments
SD/A304	SG-P1 & SG-P2	

QUESTION

1. Two gates at the pool don't appear on the gate schedule.

Not on Schedule:

Ornamental - Double Gate SG-P1 SD/A304

Ornamental - Double Gate SG-P2 SD/A304

Please provide an updated gate schedule including the gates above.

ANSWER

Do not bid scope on sheet SD/A304
or SD/A304. Sheets removed from
project in addenda 2 and 3.

Response Provided By:

Name

Company

Question Initiated By: Kenneth Yang

Harris RFIs as of 5/12/2022

On Sheet SD/A207 the dugout is bubbled and called out to refer to detail K7-SD/A410. There is no such drawing. **Please clarify**

See addenda 2 for clarification

- At the West side of the stadium. Those “foundations” are fairly accurately depicted on the structural drawings of Building(s) Q1 and Q2. However, there is no indication that there is either a weld plate or bolt template at the top of the 24” SQ Concrete columns. We assume that a weld plate will be required.

Foundation design to be verified by Bleacher vendor. Bleacher connection to foundations that span through Bldg Q1 and Q2 to be designed and engineered by bleacher vendor for submittal to DSA

- At the East side of the Stadium (For instance as depicted on SD/A208), it states: Increment 2 Outdoor Bleacher Footings See A4-SD/A503 however this detail simply shows some handrail. **Please clarify foundation requirements.** (We are assuming that it is simply a 6” thick slab?)

See addenda 3 for corrected detail reference. Foundations are to be designed by bleacher vendor and must be fully engineered and submitted to DSA for review and approval with assistance of architect after contract is awarded. Slab below bleachers is indicated to be 4” concrete walk over 6” of 90% compacted fill.

- B/A103 depicts the Grandstand Bleachers for Baseball. Detail A1 calls for “24” Outdoor Bleacher Footing Typ.” However there are no details for these footings. **Please Clarify.**

24” concrete pier assumed. Foundations are to be designed by bleacher vendor and must be fully engineered and submitted to DSA for review and approval with assistance of architect after contract is awarded. Slab below bleachers is indicated to be 4” concrete walk over 6” of 90% compacted fill.

- B/A104 Softball. Same issue. **Please clarify foundation requirements.**

24” concrete pier assumed. Foundations are to be designed by bleacher vendor and must be fully engineered and submitted to DSA for review and approval with assistance of architect after contract is awarded. Slab below bleachers is indicated to be 4” concrete walk over 6” of 90% compacted fill.