



**PROJECT:**

**STADIUM MODERNIZATION  
AT MADERA SOUTH HIGH SCHOOL  
MADERA UNIFIED SCHOOL DISTRICT**

Date : January 17, 2019

TETER Project No.: A 17-10748 D

**CLIENT:**

Madera Unified School District  
1205 South Madera Avenue  
Madera, CA 93637

District Bid No.: 111918  
DSA File No.: 20-H3  
DSA Appl. No.: 02-116986

*The following additions, deletions and revisions to the plans, specifications and Addenda shall become a part of the plans and specifications. It is the responsibility of the General Contractor to submit the information contained in this addendum to all subcontractors and suppliers. The Bidder shall acknowledge receipt of the Addendum in the Bid Proposal. (Addendum number of pages: 2 pages + 2 attachments = 4 total pages).*

**PROJECT MANUAL – INCREMENT NO. 01:**

**5 – 01: BID DOCUMENTS, DOCUMENT 011101 - “MULTIPLE CONTRACT SUMMARY”** which was added as part of Addendum 2 revise as follows:

- A. Revise Section 011101 – MULTIPLE CONTRACT SUMMARY, A., 6., line b. to read  
“Contractor to provide and replace ten comparable 1500 watt metal halide lamps to existing stadium light fixtures. Actual locations to be determined by owner. Any uninstalled new lamps are to be turned over to the owner in original packaging.”

**5 – 02: PROJECT MANUAL, SPECIFICATION SECTION 321126 - “AGGREGATE BASE COURSE”** revise as follows:

- A. Revise SPECIFICATION SECTION 321126 - “AGGREGATE BASE COURSE” 3.2.C. to read: “Spreading and Compacting - In accordance with Section 26, SSCDOT. *Aggregate base shall be spread and graded with laser-leveled grading equipment to achieve required tolerances.* The relative compaction of each layer of compacted base material shall be not less than 95 percent.

**DRAWINGS – INCREMENT NO. 01:**

**5 – 03: DRAWINGS, SHEET C201-1 - PARTIAL DEMOLITION PLAN**, revise as follows:

- A. Remove sheet PARTIAL DEMOLITION PLAN – C201-1 in its entirety and replace with attached revised sheet. Revisions have been clouded. (1 page)

## ADDENDUM NO. 05

Stadium Modernization at Madera South High School  
Page 2

**5 – 04: DRAWINGS, SHEET C202-1 - PARTIAL DEMOLITION PLAN**, revise as follows:

- A. Remove sheet PARTIAL DEMOLITION PLAN – C202-1 in its entirety and replace with attached revised sheet. Revisions have been clouded. (1 page)

**5 – 05: DRAWINGS, SHEET E101-1 – DEMOLITION ELECTRICAL SITE PLAN**, revise as follows:

- A. Add General Note C:

C. AT ALL (E) UNDERGROUND PULLBOXES TO REMAIN, CONTRACTOR SHALL RE-SET (E) PULLBOX TO BE FLUSH WITH (N) FINISHED GRADE. REFER TO CIVIL DRAWINGS FOR ADDITIONAL INFORMATION.

**CLARIFICATIONS:**

**5 – 06: DETAIL 18/A106-1**, add notes:

- A. "ALL SIGNAGE FRAMING BACKER PLATES, ETC SHALL EITHER BE POWDER COATED OR ELECTROSTATICALLY PAINTED. COLOR SHALL BE BLACK."
- B. "HAND PAINTED 3D CARVED ACRYLIC MASCOT LOGO TO HAVE A MINIMUM OF 3 COLORS. COLORS TO BE SELECTED BY ARCHITECT."

**5 – 07: DETAIL C/X103-1**, clarify:

- A. Detail does not depict a hot tap.

**END OF ADDENDUM NO. 05**

---

Robert V. Thornton,  
Architect of Record

Recipient Signature: \_\_\_\_\_  
Date: \_\_\_\_\_

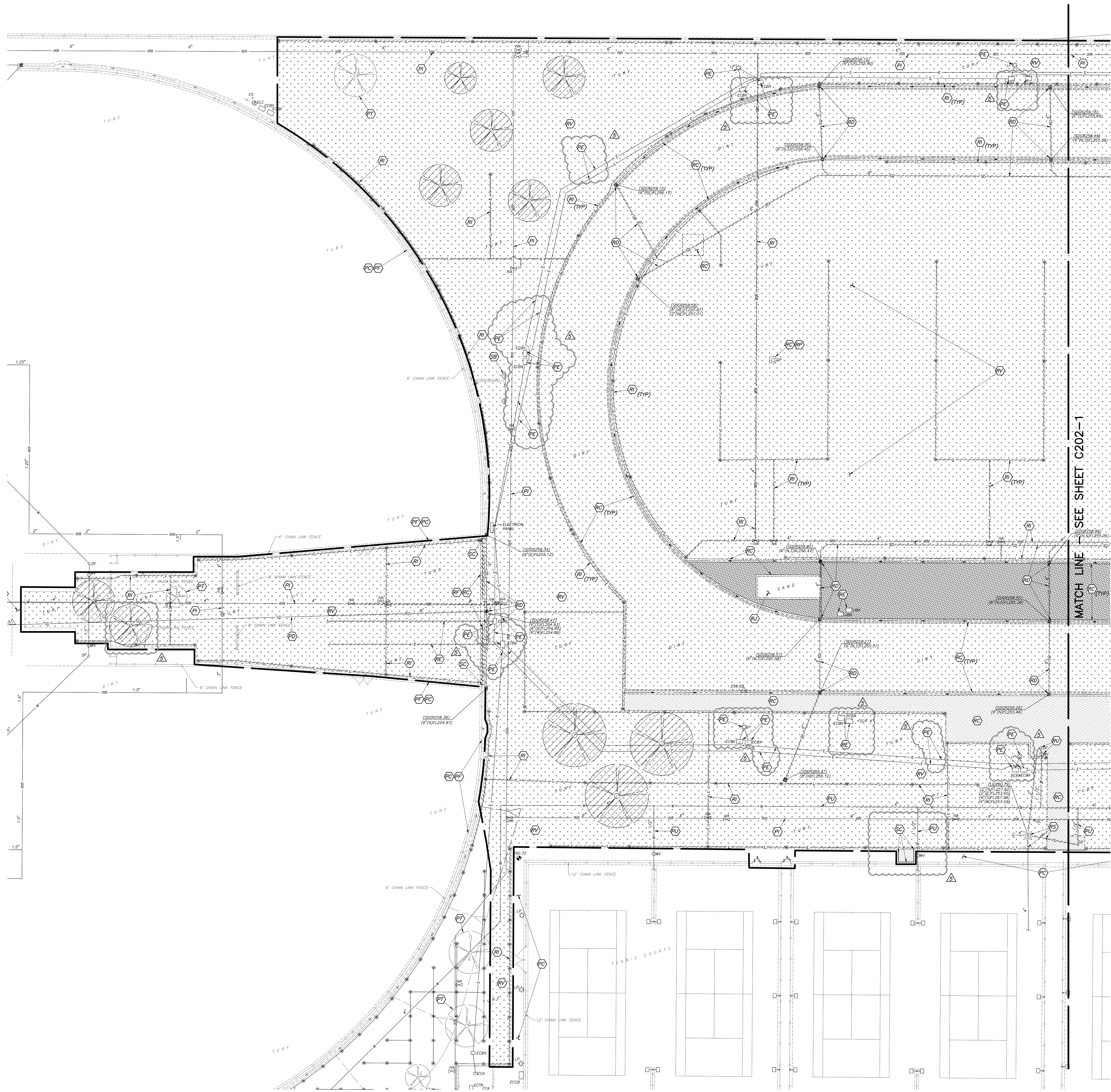

DEMOLITION LEGEND:

- LIMITS OF VEGETATION REMOVAL AND GENERAL CLEANING AND GRUBBING
- LIMITS OF CONCRETE IMPROVEMENT REMOVAL
- LIMITS OF ASPHALTIC CONCRETE PAVEMENT STRUCTURAL SECTION REMOVAL
- LIMITS OF TRACK SURFACE IMPROVEMENT REMOVAL
- PROTECT EXISTING ASPHALT CONCRETE PAVEMENT TO REMAIN
- PROTECT EXISTING CONCRETE IMPROVEMENTS TO REMAIN
- PROTECT EXISTING STORM DRAIN STRUCTURE TO REMAIN
- PROTECT EXISTING ELECTRICAL EQUIPMENT TO REMAIN
- PROTECT EXISTING IRRIGATION MAINS & LATERALS
- PROTECT EXISTING SEWER STRUCTURE TO REMAIN
- PROTECT EXISTING TREE AND ROOTS TO REMAIN
- PROTECT EXISTING UTILITY TO REMAIN
- PROTECT EXISTING CONCRETE WHEELSTOP TO REMAIN
- REMOVE ASPHALT CONCRETE PAVEMENT STRUCTURAL SECTION
- REMOVE CHAIN LINK FENCE, FABRIC, POSTS, AND FOOTINGS. SEE NOTES 10 AND 12
- REMOVE CONCRETE IMPROVEMENTS
- REMOVE STORM DRAIN, SEE NOTE 12
- REMOVE ELECTRICAL, SEE NOTE 12 AND 13
- REMOVE IRRIGATION, SEE NOTES 11 AND 12
- REMOVE JUMP PIT AND SAND, SEE NOTE 12
- REMOVE GOAL POST, SEE NOTE 12
- REMOVE SEWER, SEE NOTE 12
- REMOVE UTILITY, SEE NOTE 12
- REMOVE CONCRETE WHEELSTOP
- REMOVE VEGETATION
- PROTECT AND CLEAN EXISTING SCOREBOARD, POSTS AND FOOTINGS TO REMAIN
- SAWCUT
- REMOVE TREE, SEE NOTE 9 AND 12

GENERAL DEMOLITION NOTES:

- THE "LIMIT OF DEMOLITION" SHOWN IS APPROXIMATE AND IS GENERALLY CONSIDERED TO BE THE MINIMUM REMOVAL REQUIREMENTS. CONTRACTOR MUST COORDINATE AS NOTED IN THE LEGEND.
- CONTRACTOR SHALL LEGALLY DISPOSE OF ALL DEMOLISHED MATERIALS OFF SITE.
- CONTRACTOR SHALL PROTECT ALL EXISTING UTILITY IMPROVEMENTS NOT SPECIFICALLY DESIGNATED FOR REMOVAL.
- THE ON-SITE UNDERGROUND UTILITIES SHOWN ON THIS SHEET ARE AT AN APPROXIMATE LOCATION. THE EXTENT, LOCATIONS AND SIZES ARE UNKNOWN. THE CONTRACTOR SHALL POT-HOLE TO LOCATE AND VERIFY THE UNDERGROUND UTILITY LINES PRIOR TO REMOVAL.
- CONTRACTOR TO PROTECT AND PRESERVE IN PLACE ANY FOUND SURVEY MONUMENTS. ANY MONUMENTS DISTURBED SHALL BE RESET BY A LICENSED SURVEYOR AND THE APPROPRIATE PAPERWORK FILED WITH THE CITY OR COUNTY.
- ALL HAZARDOUS MATERIALS ENCOUNTERED DURING SITE DEMOLITION SHALL BE REMEDIATED AND DISPOSED OF PER STATE AND EPA REQUIREMENTS.
- CONTRACTOR SHALL CONTACT AND COORDINATE WITH ALL UTILITY AGENCIES PRIOR TO THE START OF ANY DEMOLITION OR CONSTRUCTION.
- ANY EXISTING UTILITIES AND/OR IMPROVEMENTS THAT BECOME DAMAGED DURING CONSTRUCTION SHALL BE COMPLETELY RESTORED TO THE SATISFACTION OF THE OWNER AND AGENCY HAVING AUTHORITY, AT THE CONTRACTOR'S SOLE EXPENSE.
- REMOVE TREES TO A MINIMUM DEPTH OF 3' OR TO BOTTOM OF ROOT BALL, WHICHEVER IS DEEPER.
- REMOVE EXISTING IMPROVEMENTS AS NECESSARY TO CONSTRUCT NEW IMPROVEMENTS SHOWN ON THESE PLANS.
  - a) FOR CONCRETE REMOVAL, REMOVE TO THE NEXT NEAREST TOOLED JOINT OR EXPANSION JOINT OF IMPROVEMENTS DESIGNATED TO REMAIN.
  - b) FOR ASPHALTIC PAVEMENT REMOVAL, SAWCUT TO A STRAIGHT, CLEAN EDGE AT LOCATIONS INDICATED ON THE PLANS.
  - c) FOR CHAIN LINK FENCING, REMOVE TO THE NEXT NEAREST POST DESIGNATED TO REMAIN AND REMOVE FABRIC TO THE NEXT NEAREST STRETCHER BAR TO REMAIN.
- COORDINATE DEMOLITION, SALVAGE, AND PROTECTION OF PLANTING AND IRRIGATION UTILITIES AND EQUIPMENT WITH PLANTING AND IRRIGATION PLANS.
- BACKFILL AND COMPACT ALL EXCAVATIONS PER THE PROJECT SPECIFICATIONS.
- COORDINATE DEMOLITION, SALVAGE, AND POST OF ELECTRICAL EQUIPMENT AND UTILITIES WITH ELECTRICAL PLANS.

- LIMIT OF CHAIN LINK FENCE REMOVAL
- LIMIT OF IRRIGATION MAIN LINE REMOVAL/ABANDONMENT
- LIMIT OF IRRIGATION LATERAL LINE REMOVAL/ABANDONMENT
- LIMIT OF SEWER LINE REMOVAL
- LIMIT OF STORM DRAIN LINE REMOVAL
- LIMIT OF STRIPING REMOVAL, SEE SPECIFICATIONS
- LIMIT OF WATER LINE REMOVAL

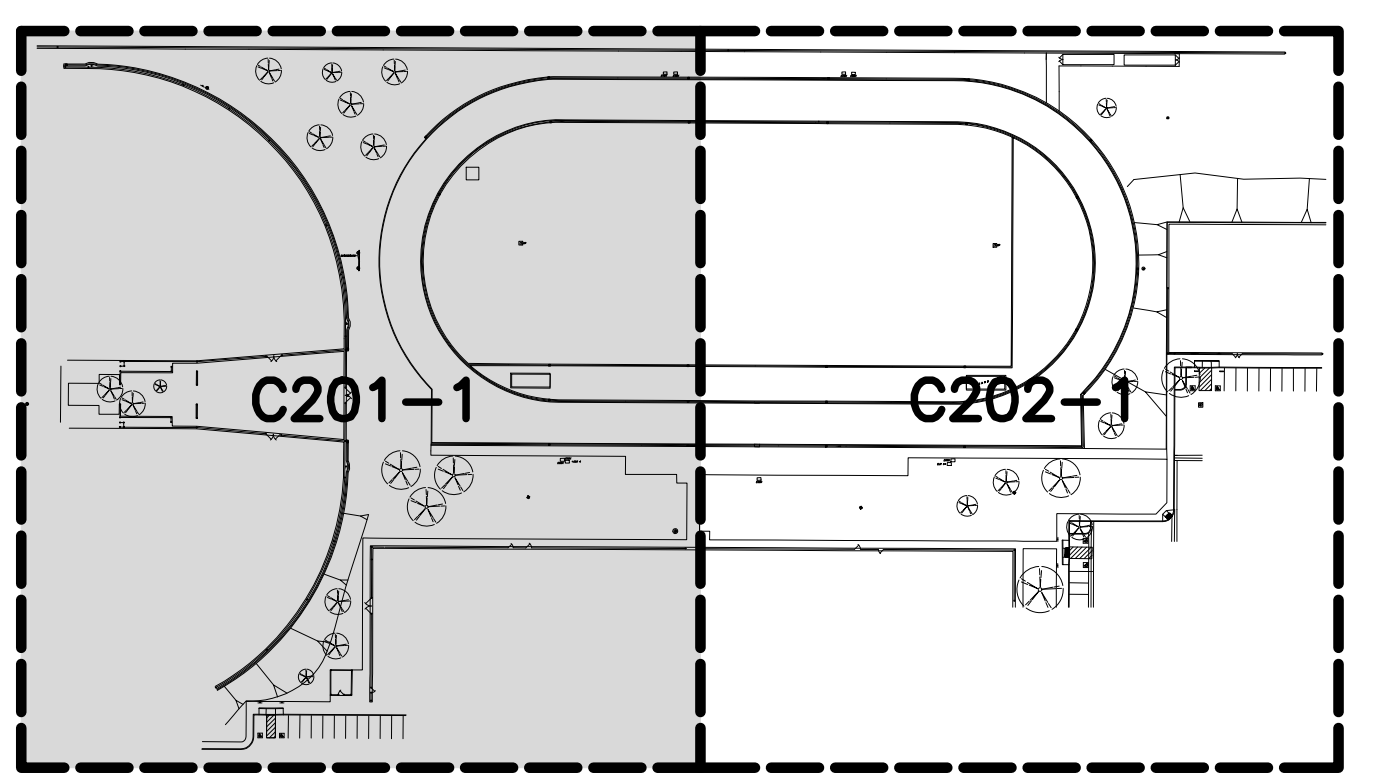

811 Know what's below. Call before you dig.

Blair, Church & Flynn CONSULTING ENGINEERS

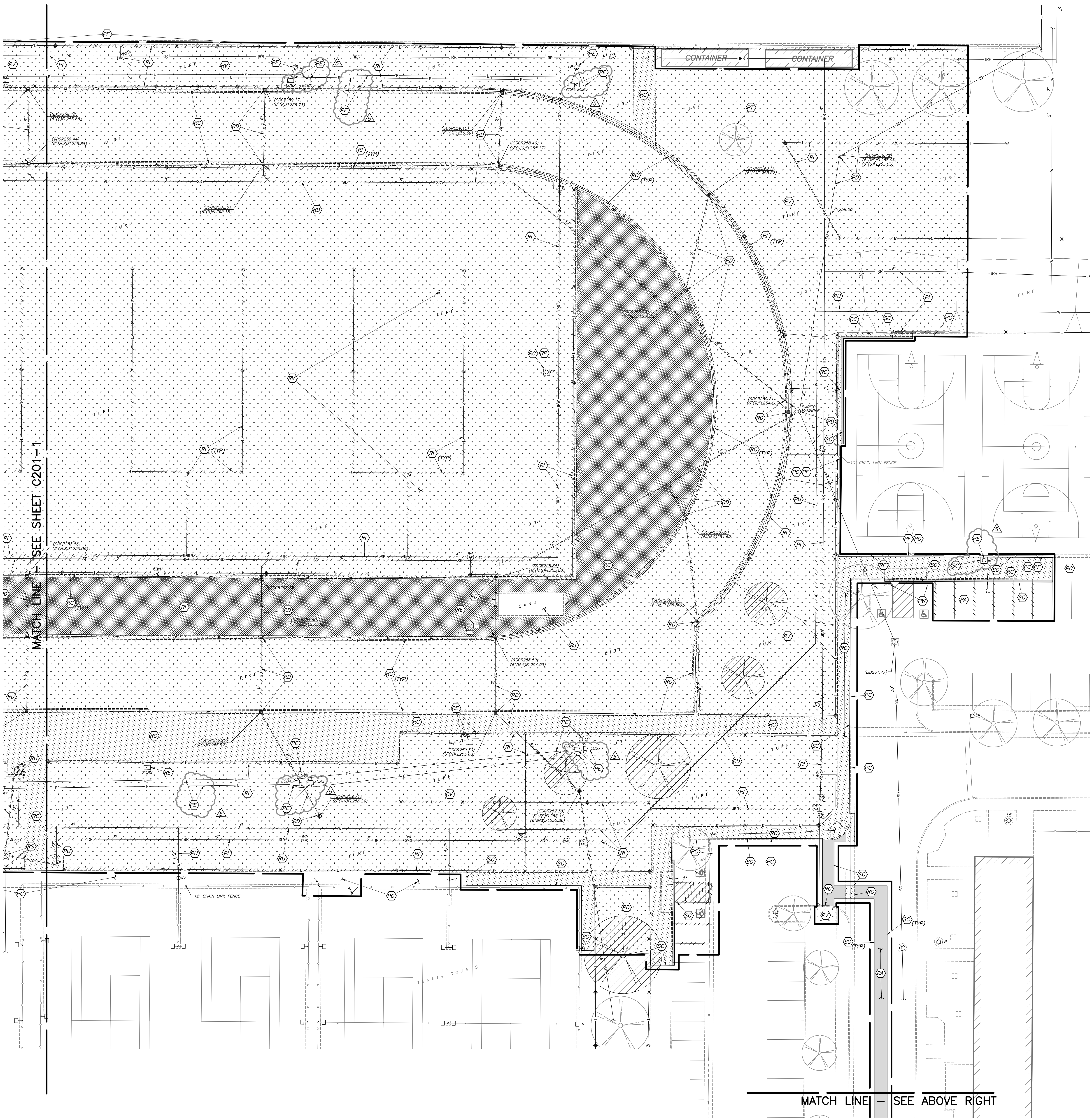

- DEMOLITION LEGEND:**
- LIMITS OF VEGETATION REMOVAL AND GENERAL CLEANING AND GRUBBING
  - LIMITS OF CONCRETE IMPROVEMENT REMOVAL
  - LIMITS OF ASPHALTIC CONCRETE PAVEMENT STRUCTURAL SECTION REMOVAL
  - LIMITS OF TRACK SURFACE IMPROVEMENT REMOVAL
  - PROTECT EXISTING ASPHALT CONCRETE PAVEMENT TO REMAIN
  - PROTECT EXISTING CONCRETE IMPROVEMENTS TO REMAIN
  - PROTECT EXISTING STORM DRAIN STRUCTURE TO REMAIN
  - PROTECT EXISTING ELECTRICAL EQUIPMENT TO REMAIN
  - PROTECT EXISTING IRRIGATION MAINS & LATERALS
  - PROTECT EXISTING SEWER STRUCTURE TO REMAIN
  - PROTECT EXISTING TREE AND ROOTS TO REMAIN
  - PROTECT EXISTING UTILITY TO REMAIN
  - PROTECT EXISTING CONCRETE WHEELSTOP TO REMAIN
  - REMOVE ASPHALT CONCRETE PAVEMENT STRUCTURAL SECTION
  - REMOVE CHAIN LINK FENCE, FABRIC, POSTS, AND FOOTINGS, SEE NOTES 10 AND 12
  - REMOVE CONCRETE IMPROVEMENTS
  - REMOVE STORM DRAIN, SEE NOTE 12
  - REMOVE ELECTRICAL, SEE NOTE 12 AND 13
  - REMOVE IRRIGATION, SEE NOTES 11 AND 12
  - REMOVE JUMP PIT AND SAND, SEE NOTE 12
  - REMOVE GOAL POST, SEE NOTE 12
  - REMOVE SEWER, SEE NOTE 12
  - REMOVE UTILITY, SEE NOTE 12
  - REMOVE CONCRETE WHEELSTOP
  - REMOVE VEGETATION
  - PROTECT AND CLEAN EXISTING SCOREBOARD, POSTS AND FOOTINGS TO REMAIN
  - SAWCUT
  - REMOVE TREE, SEE NOTE 9 AND 12
- GENERAL DEMOLITION NOTES:**
- THE "LIMIT OF DEMOLITION" SHOWN IS APPROXIMATE AND IS GENERALLY CONSIDERED TO BE THE MINIMUM REMOVAL REQUIREMENTS. CONTRACTOR MUST COORDINATE AS NOTED IN THE LEGEND.
  - CONTRACTOR SHALL LEGALLY DISPOSE OF ALL DEMOLISHED MATERIALS OFF SITE.
  - CONTRACTOR SHALL PROTECT ALL EXISTING UTILITY IMPROVEMENTS NOT SPECIFICALLY DESIGNATED FOR REMOVAL.
  - THE ON-SITE UNDERGROUND UTILITIES SHOWN ON THIS SHEET ARE AT AN APPROXIMATE LOCATION. THE EXTENT, LOCATIONS AND SIZES ARE UNKNOWN. THE CONTRACTOR SHALL POthOLE TO LOCATE AND VERIFY THE UNDERGROUND UTILITY LINES PRIOR TO REMOVAL.
  - CONTRACTOR TO PROTECT AND PRESERVE IN PLACE ANY FOUND SURVEY MONUMENTS. ANY MONUMENTS DISTURBED SHALL BE RESET BY A LICENSED SURVEYOR AND THE APPROPRIATE PAPERWORK FILED WITH THE CITY OR COUNTY.
  - ALL HAZARDOUS MATERIALS ENCOUNTERED DURING SITE DEMOLITION SHALL BE IDENTIFIED AND DISPOSED OF PER STATE AND EPA REQUIREMENTS.
  - CONTRACTOR SHALL CONTACT AND COORDINATE WITH ALL UTILITY AGENCIES PRIOR TO THE START OF ANY DEMOLITION OR CONSTRUCTION.
  - ANY EXISTING UTILITIES AND/OR IMPROVEMENTS THAT BECOME DAMAGED DURING CONSTRUCTION SHALL BE COMPLETELY RESTORED TO THE SATISFACTION OF THE OWNER AND AGENCY HAVING AUTHORITY, AT THE CONTRACTOR'S SOLE EXPENSE.
  - REMOVE TREES TO A MINIMUM DEPTH OF 3' OR TO BOTTOM OF ROOT BALL, WHICHEVER IS DEEPER.
  - REMOVE EXISTING IMPROVEMENTS AS NECESSARY TO CONSTRUCT NEW IMPROVEMENTS SHOWN ON THESE PLANS.
    - FOR CONCRETE REMOVAL, REMOVE TO THE NEXT NEAREST TOOLED JOINT OR EXPANSION JOINT OF IMPROVEMENTS DESIGNATED TO REMAIN.
    - FOR ASPHALTIC PAVEMENT REMOVAL, SAWCUT TO A STRAIGHT, CLEAN EDGE AT LOCATIONS INDICATED ON THE PLANS.
    - FOR CHAIN LINK FENCING, REMOVE TO THE NEXT NEAREST POST DESIGNATED TO REMAIN AND REMOVE FABRIC TO THE NEXT NEAREST STRETCHER BAR TO REMAIN.
  - COORDINATE DEMOLITION, SALVAGE, AND PROTECTION OF PLANTING AND IRRIGATION UTILITIES AND EQUIPMENT WITH PLANTING AND IRRIGATION PLANS.
  - BACKFILL AND COMPACT ALL EXCAVATIONS PER THE PROJECT SPECIFICATIONS.
  - COORDINATE DEMOLITION, SALVAGE, AND POST OF ELECTRICAL EQUIPMENT AND UTILITIES WITH ELECTRICAL PLANS.

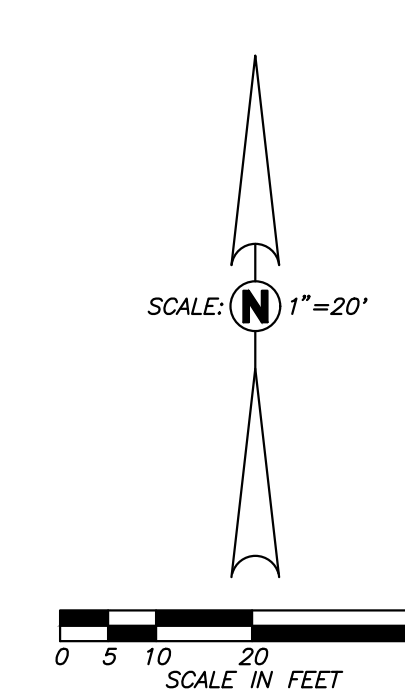
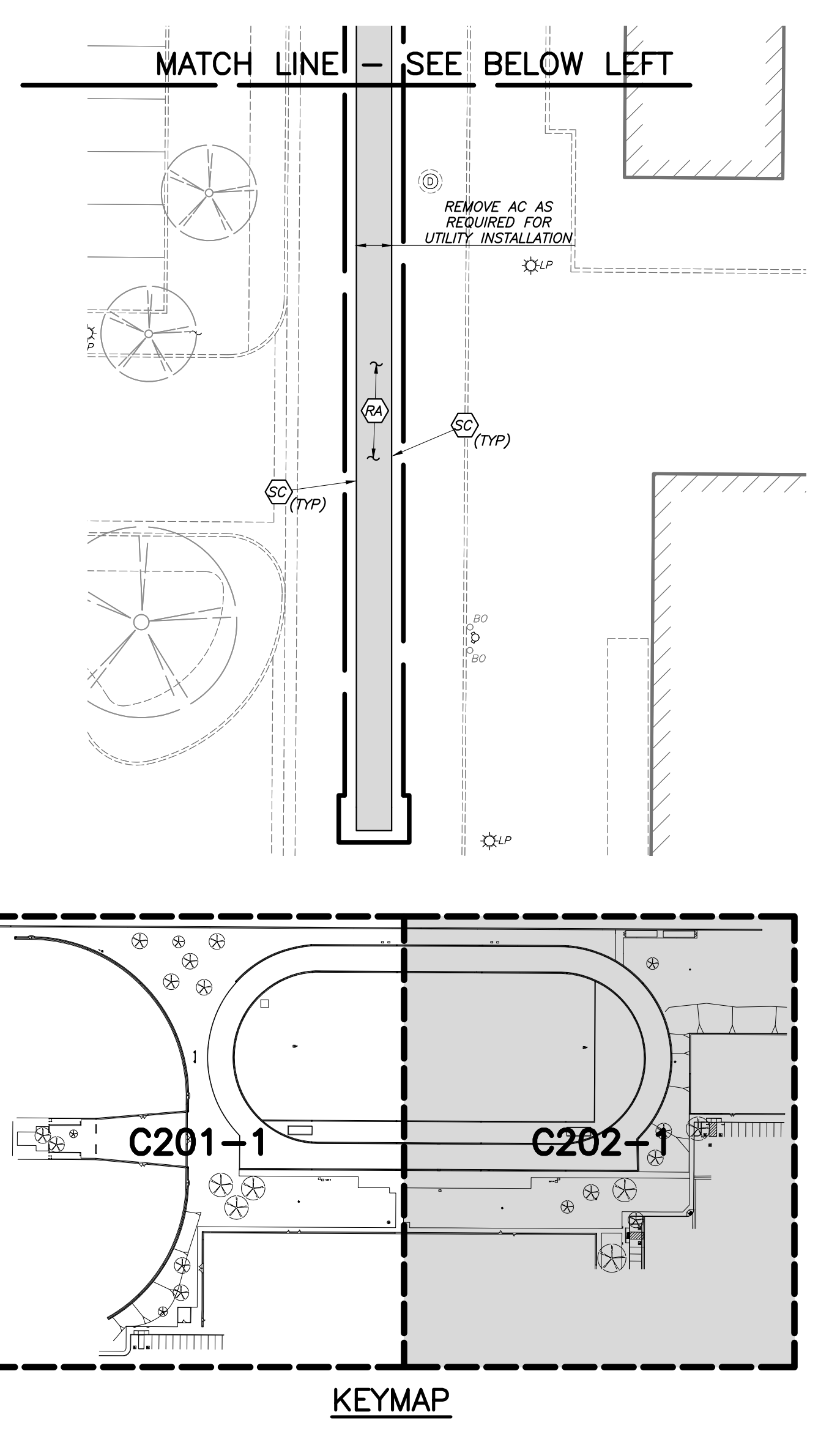

12/1/18 100% CD DSA APPROVAL

FILE NUMBER: 20-H3

IDENTIFICATION STAMP

DIVISION OF THE STATE ARCHITECT

APPL:02-116986

AC FLS SS

DATE:

**TETER, LLP**

FRESNO HEADQUARTERS

VISALIA | BAKERSFIELD | MODESTO | SAN LUIS OBISPO

ARCHITECTS ENGINEERS CONNECTED

**TETER**

STADIUM MODERNIZATION INCREMENT NO. 1

MADERA SOUTH HIGH SCHOOL

MADERA UNIFIED SCHOOL DISTRICT

MADERA, CA

DRAWING TITLE: PARTIAL DEMOLITION PLAN

PROJECT NO. 18-10748

DRAWING C202-1

01/10/19 Date Signed