

Milestone

HUSKY™ M500A

HUSKY™ M550A

Access anywhere



Milestone
Mobile



XProtect®
Web Client



XProtect®
Smart Client

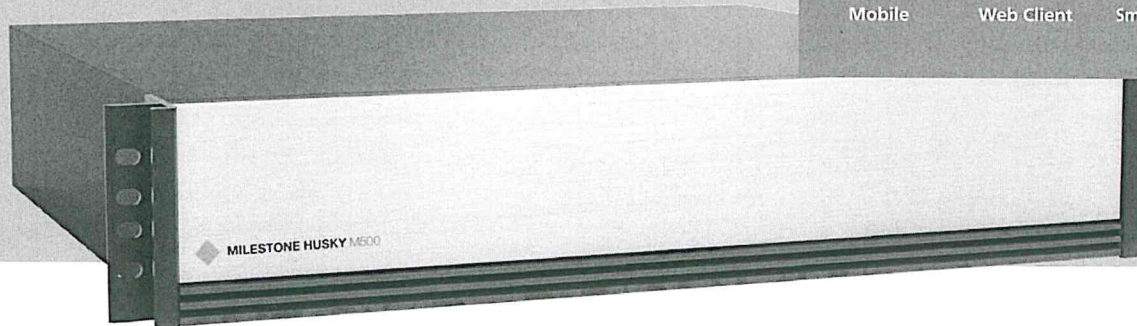

High performing NVR with scalable software

Purpose-built surveillance recording hardware with
guaranteed support of up to 1200Mb/s recording rate

Product highlights ↓

Easy system design – fast deployment

Easy to calculate system requirements
using the **Husky calculator**

Save time on installation with **pre-installed** XProtect Expert VMS,
Windows 10 operating system and
Microsoft SQL Server 2014 Express
Edition

Quick system setup with the **Husky
Assistant**, so there is less risk and
effort needed to install a recording
platform

High-performance NVR hardware platform

Guaranteed performance of **600
Mb/s** (M500A) or **1200Mb/s**
(M550A) recording rate

RAID controller is optimized for
streaming applications and supports
RAID 5/6/10/50

Western Digital Purple Drives are
optimized and designed for
surveillance NVRs

Supports up to **512/768 cameras**

Exclusive system board based on
Intel i7 CPU

Lowest NVR total cost of ownership

Industry-leading price-performance
ratio

Lower support costs with **Customer
Dashboard** providing online system
monitoring tools and backup recovery
image

Software license portability lowers
license administration and
management costs

Includes a **three-year hardware
warranty** and Milestone Care™ Plus
for investment protection

Milestone HUSKY™ M500A / M550A

Equipment Specifications

Front and rear panel

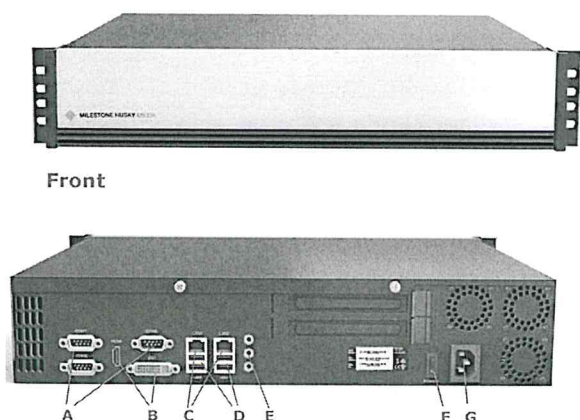

Rear interfaces

- A. 3 x COM ports
- B. 1 x HDMI / 1 x DVI*
- C. 2 x GbE RJ45
- D. 4 x USB 3.0
- E. 1 x Line-out / MIC-in / Line-in
- F. 1 x Power switch
- G. 1 x Power input (M500A), 2 x Power input (M550A)

*Local viewing should be using hardware accelerated XProtect Smart Client and may lower overall number of cameras being recorded.

M500A ordering information

SKU	Description
HM500A-XPET-8TB	Husky M500A XProtect Expert NVR, 8TB, RAID 5/10, Rack mounted, 0 device licenses
HM500A-XPET-16TB	Husky M500A XProtect Expert NVR, 16TB, RAID 5/10, Rack mounted, 0 device licenses
HM500A-XPET-32TB	Husky M500A XProtect Expert NVR, 32TB, RAID 5/10, Rack mounted, 0 device licenses
HM500A-XPET-48TB	Husky M500A XProtect Expert NVR, 48TB, RAID 5/10, Rack mounted, 0 device licenses
HM500A-XPET-64TB	Husky M500A XProtect Expert NVR, 64TB, RAID 5/10, Rack mounted, 0 device licenses
HM500A-XPETDL	Husky M500A/M550A XProtect Expert NVR device license, including three years Care Plus

M550A ordering information

SKU	Description
HM550A-XPET-8TB	Husky M550A XProtect Expert NVR, 8TB, RAID 5/10, Rack mounted, 0 device licenses
HM550A-XPET-16TB	Husky M550A XProtect Expert NVR, 16TB, RAID 5/10, Rack mounted, 0 device licenses
HM550A-XPET-32TB	Husky M550A XProtect Expert NVR, 32TB, RAID 5/10, Rack mounted, 0 device licenses
HM550A-XPET-48TB	Husky M550A XProtect Expert NVR, 48TB, RAID 5/10, Rack mounted, 0 device licenses
HM550A-XPET-64TB	Husky M550A XProtect Expert NVR, 64TB, RAID 5/10, Rack mounted, 0 device licenses
HM500A-XPETDL	Husky M500A/M550A XProtect Expert NVR device license, including three years Care Plus

Please contact your local Milestone representative to order Milestone Husky

Product specifications subject to change without notice.

Specifications

General	Detail
Form factor	2U rack-mount
Dimensions M500A	43(W) x 40(D) x 8.8(H) cm
Dimensions M550A	17(W) x 16.4(D) x 3.5(H) in 48(W) x 47(D) x 8.8(H) cm 19(W) x 18.4(D) x 3.5(H) in
Maximum number of cameras	M500A: 512, M550A: 768
Add-on camera licenses	Individually
All-in-one single unit	Yes
Multi-unit	Unlimited units, centrally managed
VMS preloaded	XProtect Expert
Milestone Care Plus	Three years included
Hardware warranty	Three years included
Updates to newer VMS version	Yes, with Care Plus
Maximum power consumption	90-120W
Storage system	Detail
Video storage	8TB/16TB/32TB/48TB/64TB
Max recording rate	M500A: 600Mb/s M550A: 1200Mbit/s
Number of ports	8
Data transfer rate	6Gb/s per port
RAID levels	5, 6, 10 and 50 included
Hot spare	Yes
Sector size	64KB
Number of drives	8
Drive type	Western Digital Purple drives
Compute system	Detail
CPU	Intel i7 3610 QE
Processor base frequency	2.3 GHz
Passmark	7463
RAM	16GB
Operating system	Windows 10
OS storage	128GB mSATA SSD
Video management system	Detail
Base license included	XProtect Expert, pre-licensed
VMS license portability	Yes
Recording Server	Yes
Failover Server	Yes, hot or cold standby
Management Server	Yes
Codec support	H.264, MJPEG, MPEG4, MxPEG
Audio support	Yes, two-way
Remote viewing and playback	Yes
Hardware accelerated decoding	Yes, XProtect Smart Client
Hardware accelerated VMD	Yes
Recovery image	Yes
VMS install wizard	Yes
Third-party application support	Yes
Milestone Interconnect support	Yes
Customer Dashboard support	Yes, with Milestone Care Plus
Power system	Detail
Power input	100 ~ 240V, 50/60 Hz, 200W
Maximum watts	M500A: 300W M550A: 400W
Accessories	Detail
Power cables	Yes, type dependent on region
Keyboard and mouse	In selected regions only
Other	Detail
Regulatory compliance	CE (class A), WEEE, FCC (class A), RCM, UL, VCCI, Mexico (CoC), South Africa (CoC)

*This device complies with Part 15 of the FCC Rules. Operation is subject to the following two conditions: (1) this device may not cause harmful interference, and (2) this device must accept any interference received: including interference that may cause undesired operation.

**This is a Class A product based on the standard of the Voluntary Control Council for Interference (VCCI). If this equipment is used in a domestic environment, radio interference may occur, in which case the user may be required to take corrective actions.

DS-2CD2722FWD-IZS

2 MP WDR Dome Network Camera with IR



Key Features

- 2 Megapixel High Resolution
- Full HD1080p Video
- Dual Video Streams
- 2.8 mm to 12 mm Motorized Lens
- 120 dB Wide Dynamic Range
- 3D Digital Noise Reduction
- Smart Features
- PoE 802.3af
- IR Range 30 Meters (~100 feet)
- IP66 and IK10 Protection
- Audio and Alarm Input/Output
- Edge Storage MicroSD Slot, 128 GB

Dimensions

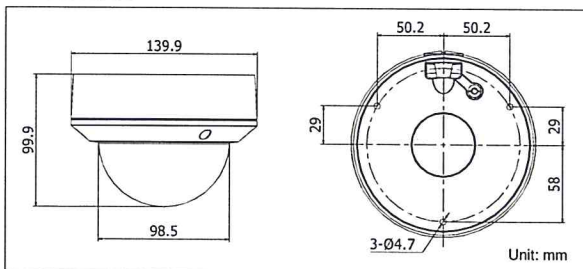

Accessories

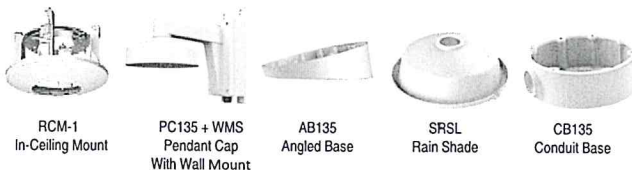

Order Model

DS-2CD2722FWD-IZS

DS-2CD2722FWD-IZS	
Camera	
Image Sensor	1/2.8" progressive scan CMOS
Minimum Illumination	Color: 0.014 lux @ (f/1.4, AGC on); B/W: 0 lux with IR
Shutter Speed	1/3 s to 1/10,000 s
Slow Shutter	Yes
Lens	2.8 mm to 12 mm @ f/1.4, motorized lens
Angle of View	106° to 35°
Lens Mount	Φ14
Day/Night	IR cut filter with auto switch/schedule/triggered by alarm
Digital Noise Reduction	3D DNR
Wide Dynamic Range	120 dB
Pan/Tilt/Rotation	Pan: 0° to 355°, tilt: 0° to 75°, rotation: 0° to 355°
Compression Standards	
Video Compression	H.264+/H.264/MJPEG
H.264 Type	Main Profile
Video Bit Rate	32 Kbps to 16 Mbps
Dual Streams	Yes
Audio	G.711/G.722.1/G.726/MP2L2, 64 Kbps (G.711)/16 Kbps (G.722.1)/16 Kbps (G.726)/32 to 128 Kbps (MP2L2)
Image	
Maximum Resolution	1920 x 1080
Frame Rate	30 fps (1920 x 1080, 1280 x 960, 1280 x 720)
Image Settings	Compression, color, saturation, brightness, contrast, sharpness, rotate mode, privacy mask
Back Light Compensation	Yes, zone configured
Region of Interest (ROI)	Yes
Analytics	
Smart Features	Line crossing detection, intrusion detection
Network	
Network Storage	NAS (supports NFS, SMB/CIFS), ANR
Alarm Triggers	Motion detection, line crossing detection, intrusion detection, tamper alarm, network disconnect, IP address conflict, storage exception
Protocols	TCP/IP, UDP, ICMP, HTTP, HTTPS, FTP, DHCP, DNS, DDNS, RTP, RTSP, RTCP, PPPoE, NTP, UPnP, SMTP, SNMP, IGMP, 802.1X, QoS, IPv6, Bonjour
Security	Three level user authentication, password authorization, HTTPS and SSH certificate, IEEE802.1X, basic and digest authentication, watermark, IP address filtering, log-in lockout
Standards	ONVIF (PROFILE S, PROFILE G), PSIA, CGI, ISAPI
Interface	
Communication	1 RJ-45 10M/100M Ethernet port
On-Board Storage	Built-in microSD/SDHC/SDXC slot, up to 128 GB
Alarm	1 alarm I/O
Audio	1 audio I/O
General	
Operating Conditions	-30° C to 60° C (-22° F to 140° F), humidity 95% or less (non-condensing)
Power	12 VDC ±10%, PoE (802.3af), UL/cUL Listed
Power Consumption	Maximum 5.5 W
IR Range	30 meters (~100 feet)
Ingress Protection	IP66
Impact Protection	IEC60068-275Eh, 20J; EN50102, up to IK10
Dimensions	Φ140 mm x 99.9 mm (Φ5.51" x 3.94")
Weight	1000 g (2.20 lbs)

MicroDome® Duo IP Megapixel Cameras

4, 6, and 10 Megapixel (MP) H.264 All-in-One Remote Focus User-Configurable Multi-Sensor True Day/Night Indoor/Outdoor Dome IP Cameras with SNAPstream™ (Smart Noise Adaptation and Processing) and WDR (Wide Dynamic Range) Models



The MicroDome® Duo series features twin multi-megapixel cameras in a compact housing, and is ideal for a variety of professional indoor/outdoor surveillance requirements. Applications include coverage of a hallway or walkway, monitoring POS terminals or ATMs, or for viewing of a single wide area or two distinct regions.

The extremely compact MicroDome Duo series offers 4-, 6-, or 10-megapixel resolution models, with choice of 2.1mm, 2.8mm, 4mm, 6mm, 8mm, 12mm, or 16mm lenses. The MicroDome Duo is ideal for applications with challenging lighting conditions regardless the time of day, supported by dual day/night mechanical IR cut filters. For applications with strong backlighting, reflections from wet flooring/puddles, or contrast due to fog, mist, or glare, Wide Dynamic Range (WDR) is available on select 4- and 6-megapixel models. MicroDome Duo features CorridorView™ for better coverage of hallways and corridors.

MicroDome Duo includes SNAPstream™ (Smart Noise Adaptation and Processing) technology to reduce bandwidth without impacting image quality. Built-in remote focus capability allows installers to simply click “Short-range Focus” or “Full-range Focus” for rapid setup. The three-axis lens adjustment provides multiple camera placement options, allowing the MicroDome Duo to be easily mounted on a wall or ceiling, while the installer can pan, tilt, and rotate the lens in a variety of directions for a precise field of view.

The installer-friendly MicroDome Duo enclosure shortens the installation process. MicroDome Duo is in an IP66 rated surface mount for use in both indoor and outdoor applications. All models feature an impact resistant, IK-10 rated cast-aluminum housing with dual polycarbonate bubbles, capable of withstanding the equivalent of 55 kg (120 lbs) of force.



Interchangeable Lenses with Remote Focus Module



SNAPstream™ Technology



CorridorView™ with 90° Image Flip



Hallway Capable



Wide Dynamic Range on Select 4 and 6MP Models



True Day/Night with IR Cut Filter



Pixel Binning Mode on 6 and 10MP Models



Ultra Low Profile Design



3-Axis Gimbal



Impact / Weather Resistant IK-10 and IP66 Rated

Series Features

- 4, 6, or 10MP Models
- SNAPstream™ (Smart Noise Adaptation and Processing) Technology Reduces Bandwidth without Impacting Image Quality
- Strong Low Light Performance with Binning Mode for 6MP and 10MP Models
- True Day/Night Functionality with Mechanical IR Cut Filter
- True WDR up to 100dB at Full Resolution Available in Select 4MP and 6MP Models
- CorridorView™ Allows 90° Image Rotation for Better Coverage in Hallways and Corridors
- Dual Encoder H.264/MJPEG
- Remote Focus Module
- Privacy Mask, Motion Detection, Flexible Cropping, Bit Rate Control, Multi-Streaming, Multicasting, and Forensic Zooming
- Multiple Lens Options Available (Sold Separately)
- Network Protocols Include DHCP, and More
- All-in-One H.264 Total Power Over Ethernet (PoE) Solution
- Easily Adjustable 3-Axis Gimbal
- Ultra Low Profile Design / Small Size
- IK-10 Impact-Resistant Housing
- Outdoor Rated IP66

Camera Imaging Specifications

Model		AV4655DN	AV4656DN	AV6655DN	AV6656DN	AV10655DN
Image Sensor (CMOS)		4MP (2 x 1080p)	4MP (2 x 1080p)	6MP (2 x 3MP)	6MP (2 x 3MP)	10MP (2 x 5MP)
Optical Format		1/3"	1/3.2"	1/3"	1/3.2"	1/2.5"
Pixel Pitch		2.2µm	2.2µm	2.2µm	2.2µm	2.2µm
Minimum Illumination	Color (Day Mode)	0.2 Lux	0.2 Lux	0.2 Lux	0.2 Lux	0.3 Lux
	Color Binning (Day Mode)	-	-	0.1 Lux	0.1 Lux	0.15 Lux
	B/W (Night Mode)	0.02 Lux, IR sensitive	0.02 Lux, IR sensitive	0.02 Lux, IR sensitive	0.02 Lux, IR sensitive	0.03 Lux, IR sensitive
Full FOV Resolution	Total	3840 H x 1080 V	3840 H x 1080 V	4096 H x 1536 V	4096 H x 1536 V	5120 H x 1920 V
	Per Sensor	1920 H x 1080 V	1920 H x 1080 V	2048 H x 1536 V	2048 H x 1536 V	2560 H x 1920 V
1/4 Resolution	Total	1920 H x 540 V	1920 H x 540 V	2048 H x 768 V	2048 H x 768 V	2560 H x 960 V
	Per Sensor	960 H x 540 V	960 H x 540 V	1024 H x 768 V	1024 H x 768 V	1296 H x 960 V
Dynamic Range		69.5dB	WDR up to 100dB	69.5dB	WDR up to 100dB	70.1dB
Frame Rates	At Max Resolution	15fps (3840 x 1080)	15fps (3840 x 1080)	10fps (4096 x 1536)	10fps (4096 x 1536)	7fps (5120 x 1920)
	1/4 Resolution	24fps (1920 x 590)	24fps (1920 x 590)	17fps (2048 x 768)	17fps (2048 x 768)	10fps (2560 x 960)
	Binning Mode	-	-	34fps (2048 x 768)	17fps (2048 x 768)	26fps (2560 x 960)
Lens	2.8mm Lens Option (-28 Models)	2.8mm, F1.8, H-FOV = 83°	2.8mm, F1.8, H-FOV = 83°	2.8mm, F1.8, H-FOV = 88°	2.8mm, F1.8, H-FOV = 88°	2.8mm, F1.8, H-FOV = 114°
	8mm Lens Option (-08 Models)	8mm, F1.6, H-FOV = 30°	8mm, F1.6, H-FOV = 30°	8mm, F1.6, H-FOV = 33°	8mm, F1.6, H-FOV = 33°	8mm, F1.6, H-FOV = 43°

Programmability

Optics	M12 lens and remote focus module
Low Light Performance	Pixel Binning Mode 6MP and 10MP models
Picture-in-Picture	Simultaneous delivery of full field-of-view and zoomed images
Programmable Shutter Speed	Controls motion blur, 1ms – 500ms
Motion Detection	Real-time, 1024 detection zones
Privacy Masking	Unlimited
Flexible Cropping	Any resolution multiple of 2 for H.264; any image width multiple of 64 for JPEG full resolution; any image width multiple of 128 for JPEG half resolution (no restriction on image height for JPEG)
Backlight Compensation	Reference windows for auto exposure and white balance
Flicker Control	50/60Hz selectable
Image Rotation	CorridorView™ (90°, 180° and 270° image rotation)
Wide Dynamic Range	Auto switch control adjustment between WDR and LDR modes (WDR models)
Noise Reduction	SNAPstream™ (Smart Noise Adaptation and Processing) technology
Efficiency	Bit rate and bandwidth limitation control Bandwidth and storage savings by running at 1/4 resolution
Sharpness	Selectable enhancement level
Miscellaneous	Programmable resolution, brightness, saturation, gamma, tint Electronic pan, tilt, zoom (PTZ)

Data Transmission

Compression Type	H.264 (MPEG-4, Part 10)/Motion JPEG 21 levels of quality
Network Protocols	RTSP, RTP/TCP, RTP/UDP, HTTP, DHCP, TFTP
Network Interface	100Base-T Ethernet
Multi-Streaming	8 non-identical streams

Compliance

Industry Standard	ONVIF Profile S
Listings	UL (CB)
FCC Compliance	47 CFR 15 Class A
Environmental	RoHS, REACH, WEEE
Markings	(CE) EN55022 Class A, EN55024, EN61000-3-2, EN61000-3-3, EN60950-1
Mechanical	IP66 (EN60529), IK-10
CoO	Made in the USA

Environmental

Operating temperature	-40°C (-40°F) to +50°C (122°F)
Humidity	0% to 90% (non-condensing)
Storage temperature	-40°C (-4°F) to +60°C (140°F)

Electrical

Alarm Input/Output	General purpose opto-coupled, 1 input/1 output
Power Over Ethernet	PoE 802.3af, Class 3
Power Consumption	7.9 Watts DC Power max

See Next Page for Mechanical Specs

MicroDome® Duo IP Megapixel Cameras

Specifications

Mechanical

Casing	Tamper-resistant housing, IK-10 Impact-resistant		
	Surface mount with die-cast aluminum housing and 2" polycarbonate dome bubble		
	IP66 weather proof standard		
	3/4" NPT		
Mount	Mount plate with electrical box adapter holes (included)		
Gimbal	Easily adjustable, 3-axis w/360° pan, 90° tilt, and 360° z-axis		
Dimensions (See Dimensions)	Unit	2.83" H (71.9mm) x 4.06" W (103mm) x 6.42" L (163mm)	
	Packaged	3.74" H (95mm) x 4.72" W (120mm) x 7.09" L (180mm)	
Weight	Unit	1.95lbs (0.88kg)	
	Packaged	2.4lbs (1.09kg)	

Quick Installation

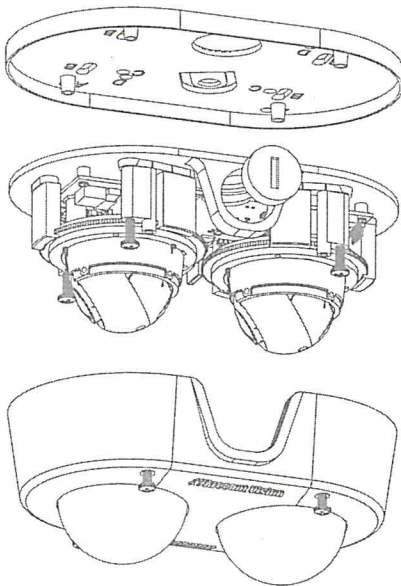

Dimensions

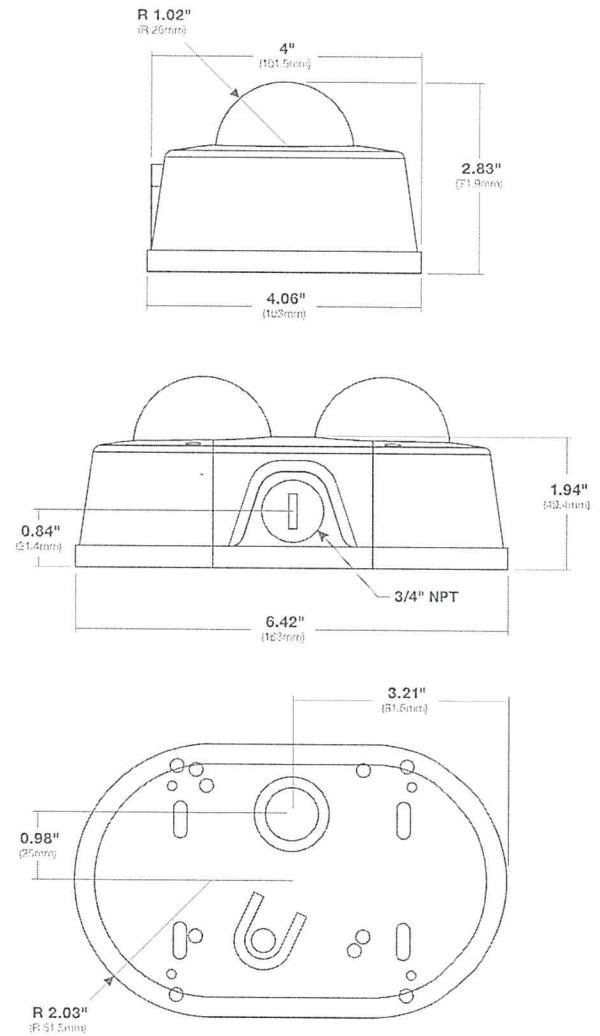

See Next Page for Ordering Information

MicroDome® Duo IP Megapixel Cameras

Specifications

Ordering Information



Model Numbers

4MP	AV4655DN-28	AV4655DN-08	AV4655DN-NL
	AV4656DN-28 <small>WDR</small>	AV4656DN-08 <small>WDR</small>	AV4656DN-NL <small>WDR</small>
6MP	AV6655DN-28	AV6655DN-08	AV6655DN-NL
	AV6656DN-28 <small>WDR</small>	AV6656DN-08 <small>WDR</small>	AV6656DN-NL <small>WDR</small>
10MP	AV10655DN-28	AV10655DN-08	AV10655DN-NL

Model Specific Features

Model	Resolution	Frame Rate	Features	
AV4655DN	4MP	15fps	-	-
AV4656DN	4MP	15fps	WDR	-
AV6655DN	6MP	10fps	-	Binning
AV6656DN	6MP	10fps	WDR	Binning
AV10655DN	10MP	7fps	-	Binning

Options

-28	2.8mm Lens
-08	8mm Lens
-NL	No Lens

Lens Options (Sold Separately)

Model	Focal Length	Horizontal Field of View					
		1.2MP	1080p	1080p WDR	3MP	3MP WDR	5MP
MPM2.1	2.1mm	130°	113°	113°	121°	121°	-
MPM2.8A*	2.8mm	95°	83°	83°	89°	89°	113°
MPM4.0A	4mm	67°	59°	59°	63°	63°	80°
MPM6.0	6mm	46°	40°	40°	43°	43°	56°
MPM8.0	8mm	35°	30°	30°	33°	33°	42°
MPM12.0A	12mm	23°	20°	20°	22°	22°	28°
MPM16.0	16mm	17°	15°	15°	16°	16°	20°

* MPM2.8A (2.8mm) is the default lens with the exception of "-NL" models

Accessories

AV-EBAS	Square electrical box adapter plate accessory
MDD-CMT	Pendant mount for MicroDome® Duo
MDD-FMA	Flush mount adapter for MicroDome Duo
MDD-WMT	Wall mount for MicroDome Duo

Configurations

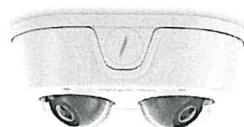

Create Your Model (Example: AV10655DN-08)

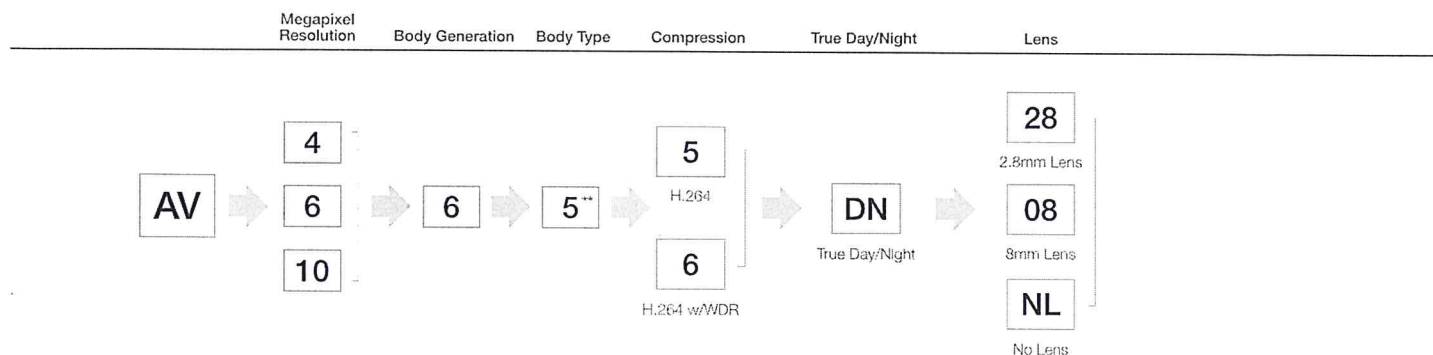

** "5" represents the MicroDome series product line

DS-2CD2642FWD-IZS

4 MP WDR Varifocal Bullet Network Camera

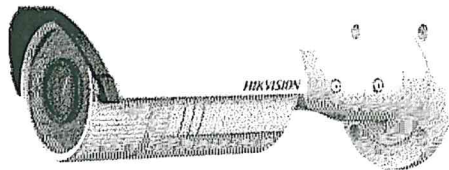

Key Features

- 4 Megapixel High Resolution
- Full HD1080p Video
- Dual Video Streams
- 2.8 mm to 12 mm Motorized Lens
- 120 dB Wide Dynamic Range
- 3D Digital Noise Reduction
- Smart Features
- PoE (802.3af)
- IR Range 30 Meters (~100 Feet)
- IP67 Protection
- Audio and Alarm Input/Output
- Edge Storage, MicroSD Slot, 128 GB

Dimensions

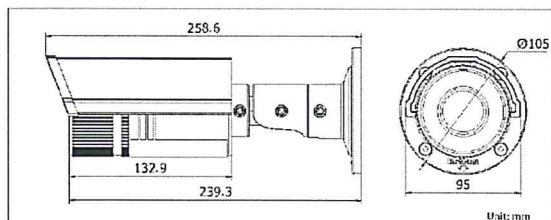

Accessories

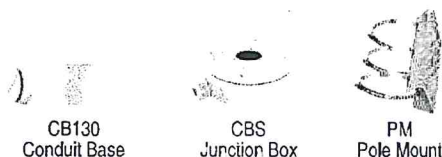

Order Model

DS-2CD2642FWD-IZS

DS-2CD2642FWD-IZS	
Camera	
Image Sensor	1/3" progressive scan CMOS
Minimum Illumination	0.014 lux @ (f/1.4, AGC on), 0 lux with IR
Shutter Speed	1/3 s to 1/10,000 s
Slow Shutter	Yes
Lens	2.8 mm to 12 mm @ f/1.4 motorized lens
Angle of View	112° to 33.8°
Lens Mount	Φ14
Day/Night	IR cut filter with auto switch
Digital Noise Reduction	3D DNR
Wide Dynamic Range	120 dB
Pan/Tilt/Rotation	3-axis positioning
Compression Standards	
Video Compression	H.264+/H.264/MJPEG
H.264 Type	Main Profile
Video Bit Rate	32 Kbps to 16 Mbps
Dual Streams	Yes
Audio	G.711/G.722.1/G.726/MP2L2/64 Kbps (G.711)/16 Kbps (G.722.1)/16 Kbps (G.726)/32 to 128 Kbps (MP2L2)
Image	
Maximum Resolution	2688 × 1520
Frame Rate	20 fps (2688 × 1520), 30 fps (1920 × 1080, 1280 × 720)
Image Setting	Compression, color, saturation, brightness, contrast, sharpness, rotate mode, privacy mask
Backlight Compensation	Yes, zone configured
Region of Interest (ROI)	Yes
Analytics	
Smart Features	Line crossing detection, intrusion detection
Network	
Network Storage	NAS (supports NFS, SMB/CIFS); ANR
Alarm Triggers	Motion detection, line crossing detection, intrusion detection, tamper alarm, network disconnect, IP address conflict, storage exception
Protocols	TCP/IP, UDP, ICMP, HTTP, HTTPS, FTP, DHCP, DNS, DDNS, RTP, RTSP, RTCP, PPPoE, NTP, UPnP, SMTP, SNMP, IGMP, 802.1X, QoS, IPv6, Bonjour
Security	Three level user authentication, password authorization, HTTPS and SSH certificate, IEEE802.1X, basic and digest authentication, watermark, IP address filtering, log-in lockout
Standards	ONVIF (PROFILE S, PROFILE G), PSIA, CGI, ISAPI
Interface	
Communication	1 RJ-45 10M/100M Ethernet port
On-Board Storage	Built-in microSD/SDHC/SDXC slot, up to 128 GB
Alarm	1 alarm I/O
Audio	1 audio I/O
General	
Operating Conditions	-30° C to 60° C (-22° F to 140° F), humidity 95% or less (non-condensing)
Power	12 VDC ±10%, PoE (802.3af)
Power Consumption	Maximum 5.5 W (maximum 7.5 W with IR cut filter on)
IR Range	30 meters
Ingress Protection	IP67
Dimensions	95 mm × 105 mm × 258.6 mm (3.74" × 4.13" × 10.18")
Weight	1200 g (2.65 lbs)

DS-2CD2722FWD-IZS

2 MP WDR Dome Network Camera with IR



Key Features

- 2 Megapixel High Resolution
- Full HD1080p Video
- Dual Video Streams
- 2.8 mm to 12 mm Motorized Lens
- 120 dB Wide Dynamic Range
- 3D Digital Noise Reduction
- Smart Features
- PoE 802.3af
- IR Range 30 Meters (~100 feet)
- IP66 and IK10 Protection
- Audio and Alarm Input/Output
- Edge Storage MicroSD Slot, 128 GB

Dimensions

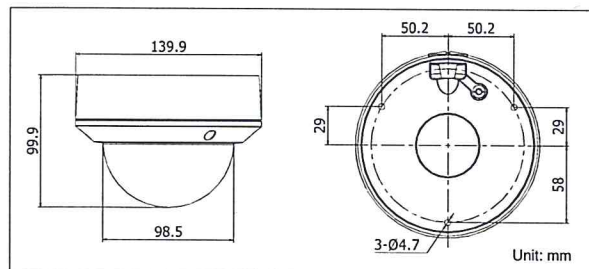

Accessories

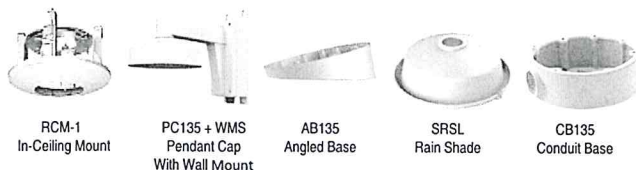

Order Model

DS-2CD2722FWD-IZS

DS-2CD2722FWD-IZS	
Camera	
Image Sensor	1/2.8" progressive scan CMOS
Minimum Illumination	Color: 0.014 lux @ (f/1.4, AGC on); B/W: 0 lux with IR
Shutter Speed	1/3 s to 1/10,000 s
Slow Shutter	Yes
Lens	2.8 mm to 12 mm @ f/1.4, motorized lens
Angle of View	106° to 35°
Lens Mount	Φ14
Day/Night	IR cut filter with auto switch/schedule/triggered by alarm
Digital Noise Reduction	3D DNR
Wide Dynamic Range	120 dB
Pan/Tilt/Rotation	Pan: 0° to 355°, tilt: 0° to 75°, rotation: 0° to 355°
Compression Standards	
Video Compression	H.264+/H.264/MJPEG
H.264 Type	Main Profile
Video Bit Rate	32 Kbps to 16 Mbps
Dual Streams	Yes
Audio	G.711/G.722.1/G.726/MP2L2, 64 Kbps (G.711)/16 Kbps (G.722.1)/16 Kbps (G.726)/32 to 128 Kbps (MP2L2)
Image	
Maximum Resolution	1920 x 1080
Frame Rate	30 fps (1920 x 1080, 1280 x 960, 1280 x 720)
Image Settings	Compression, color, saturation, brightness, contrast, sharpness, rotate mode, privacy mask
Back Light Compensation	Yes, zone configured
Region of Interest (ROI)	Yes
Analytics	
Smart Features	Line crossing detection, intrusion detection
Network	
Network Storage	NAS (supports NFS, SMB/CIFS), ANR
Alarm Triggers	Motion detection, line crossing detection, intrusion detection, tamper alarm, network disconnect, IP address conflict, storage exception
Protocols	TCP/IP, UDP, ICMP, HTTP, HTTPS, FTP, DHCP, DNS, DDNS, RTP, RTSP, RTCP, PPPoE, NTP, UPnP, SMTP, SNMP, IGMP, 802.1X, QoS, IPv6, Bonjour
Security	Three level user authentication, password authorization, HTTPS and SSH certificate, IEEE802.1X, basic and digest authentication, watermark, IP address filtering, log-in lockout
Standards	ONVIF (PROFILE S, PROFILE G), PSIA, CGI, ISAPI
Interface	
Communication	1 RJ-45 10M/100M Ethernet port
On-Board Storage	Built-in microSD/SDHC/SDXC slot, up to 128 GB
Alarm	1 alarm I/O
Audio	1 audio I/O
General	
Operating Conditions	-30° C to 60° C (-22° F to 140° F), humidity 95% or less (non-condensing)
Power	12 VDC ±10%, PoE (802.3af), UL/cUL Listed
Power Consumption	Maximum 5.5 W
IR Range	30 meters (~100 feet)
Ingress Protection	IP66
Impact Protection	IEC60068-275Eh, 20J; EN50102, up to IK10
Dimensions	Φ140 mm x 99.9 mm (Φ5.51" x 3.94")
Weight	1000 g (2.20 lbs)

HIKVISION

DS-2CD63C2F-I(V)(S)
12 MP Network Fisheye Camera



DS-2CD63C2F-I(V)(S) is a fisheye network camera capable of providing a 360 degree panoramic image of its surveillance scene.

The progressive scan CMOS sensor provides high-resolution images of up to 4000 × 3072.

Up to 14 live view display modes, designed for 3 mount types and 2 decoding modes, meet the major needs of different preference.

IR range of 15 meters provides good visibility in low or even zero-light environment.

- 1/1.7" Progressive Scan CMOS
- Max. 4000 × 3072 @20fps
- Up to 14 live view display modes
- Digital WDR
- Up to 15m IR range
- Built-in microphone and speaker
- 2 behavior analyses, 1 statistic
- With – V model: IK10 for camera housing, IP66



Function Description

Smart

- 2 behavior analyses, line crossing detection and intrusion detection
- 1 statistic, heat map
- Smart recording: Support edge recording and dual-VCA
- Smart encoding: Support low bit rate, low latency, ROI enhance encoding

Image

- Max. 4000 × 3072 @20fps
- Support live view image decoded by hardware and software
- Support up to 14 display modes in total
- Streaming smoothness setting for different requirements of image quality and fluency
- Support H.264+/H.264/MJPEG video compression, multi-level video quality configuration; support Baseline Profile/Main Profile/High Profile H.264 encoding complexity
- Multiple OSD color: Black & white self-adaptive; Custom
- Digital WDR is supportable for backlight environment
- Support BLC

System

- Support ONVIF (profile S/profile G), ISAPI protocol
- Support dual streams, and support 20 channels live view at the same time
- Lightning protection, surge protection, voltage transient protection, anti-static protection

Interface

- Support standard 128G microSD/SDHC/SDXC card storage
- Support 10M/100M Ethernet port. Support RS-485 (with – S model)
- Support Audio I/O, support stereo audio (with – S model)
- Support Alarm I/O (with – S model)

Security

- Support three-level user authentication management, user and password authorization, and IP address filtering
- Support security certificate as HTTPS
- Lock user IP after certain times failed login attempts

Specifications

Camera	
Image Sensor	1/1.7" Progressive Scan CMOS
Min. Illumination	0.01 Lux @ (F1.2, AGC ON), 0.04 Lux @ (F2.4, AGC ON), 0 Lux with IR
Shutter Speed	1/3 s – 1/100,000 s
Slow Shutter	Support
Lens	2 mm @F2.4, horizontal field of view: 180° (wall mount), 360°(ceiling mount), 360°(table mount)
Lens Mount	M12
Day & Night	IR Cut Filter
Digital Noise Reduction	3D DNR
WDR	Digital WDR
Compression Standard	
Video Compression	Main stream: H.264 Sub stream: H.264/MJPEG
H.264 Type	Baseline Profile/Main Profile/High Profile
H.264+	Support only when the display mode is Fisheye View
Video Bit Rate	256 Kbps – 16 Mbps
Audio Compression	G.711/G.722.1/G.726/MP2L2/PCM
Audio Bit Rate	64Kbps(G.711)/16Kbps(G.722.1)/16Kbps(G.726)/32-160Kbps(MP2L2)
Image	
Max. Resolution	4000 × 3072
Fisheye View Main Stream Max. Frame Rate	50Hz: 20fps (4000 × 3072), 25fps(3072 × 3072, 2560 × 2560) 60Hz: 20fps (4000 × 3072), 24fps(3072 × 3072), 30fps(2560 × 2560)
Fisheye View Sub Stream Max. Frame Rate	50Hz: 12.5fps (720 × 720, 704 × 576) 60Hz: 15fps (720 × 720, 704 × 480)
Image Enhancement	BLC/3D DNR
Image Setting	Saturation, Brightness, Contrast, Sharpness adjustable by client software or web browser
Region of Interest	Support 3 fixed region for each stream
Day/Night Switch	Auto/Schedule/Triggered by Alarm In
Picture Overlay	LOGO picture can be overlaid on video with 128 × 128 24bit bmp format
Live View Display	
Mount Type	Support table, wall, and ceiling
Decoding Mode	Support hardware decoding and software decoding
Display Mode	Support 14 display modes in total (including display modes of different mount types and decoding modes): Fisheye View, 180 Panorama View, 4PTZ, Fisheye + 3PTZ, 360 Panorama View, 360 Panorama + PTZ, 360 Panorama + 3PTZ, 360 Panorama + 6PTZ, 360 Panorama + 8PTZ, 2PTZ, Fisheye + 8PTZ, Panorama View, Panorama + 3PTZ, Panorama + 8PTZ
Audio (With -S model)	
Environment Noise Filtering	Support
Audio I/O	Support
Audio Sampling Rate	Max. 48 kHz
Smart Feature-set	
Intrusion Detection	Enter and loiter in a pre-defined virtual region, up to 4 pre-defined virtual regions supported
Line Crossing Detection	Cross a pre-defined virtual line, up to 4 pre-defined virtual lines supported
Heat Map	A graphical representation of density of visit in a configured area.

Network	
Network Storage	Support microSD/SDHC/SDXC card (128G), local storage and NAS (NFS,SMB/CIFS), ANR
Alarm Trigger	Motion detection, video tampering alarm, network disconnected, IP address conflicted, illegal login, HDD full, HDD error
Protocols	TCP/IP, UDP, ICMP, HTTP, HTTPS, FTP, DHCP, DNS, DDNS, RTP, RTSP, RTCP, PPPoE, NTP, UPnP, SMTP, SNMP, IGMP, 802.1X, QoS, IPv6, Bonjour
General Function	One-key reset, anti-flicker, heartbeat, password protection, privacy mask, watermark, IP address filter
Standard	ONVIF (PROFILE S, PROFILE G), ISAPI
Interface	
Communication Interface	1 RJ45 10M/100M Ethernet port With –S model: 1 RS-485 interface
Audio Input	1 3.5mm audio interface, Mic in/Line in (with – S model); 1 built-in microphone by default, -42dB
Audio Output	1 3.5mm audio output interface (with – S model); 1 built-in speaker by default, support echo cancellation
Alarm (With –S model)	1 input, 1 output (up to DC24V 1A or AC110V 500mA)
On-board storage	Built-in Micro SD/SDHC/SDXC slot, up to 128 GB
Reset Button	Yes
General	
Operating Conditions	Indoor temperature: -10 °C to +50 °C (14 °F to +122 °F) With –V model: Outdoor temperature: -30 °C to +60 °C (-22 °F to +140 °F) Humidity 95% or less (non-condensing)
Power Supply	DC 12 V ± 10%, 0.94 A PoE (802.3at, class 4), 0.41 – 0.26 A
Power Consumption	Max. 14.7 W
IR Range	15 m
Protection Level	With – V model: IEC60068-2-75Eh, 20J; EN50102, up to IK10 for camera housing With – V model: IP66
Dimensions	164 × 152.8 × 43.8 mm (6.46" × 6.02" × 1.72") With –V model: 164 × 152.8 × 49.5 mm (6.46" × 6.02" × 1.95")
Weight	1400 g (3.09 lbs)

Note: for detailed resolution of each display mode, consult the dealer or the technical support.

Order Models:

DS-2CD63C2F-I; DS-2CD63C2F-IV; DS-2CD63C2F-IS; DS-2CD63C2F-IVS

*-S: with 1 audio input (Mic in/line in), 1 audio output, 1 RS-485, 1 alarm input and 1 alarm output

*-V: with protection level of IK 10 and IP66

Dimensions

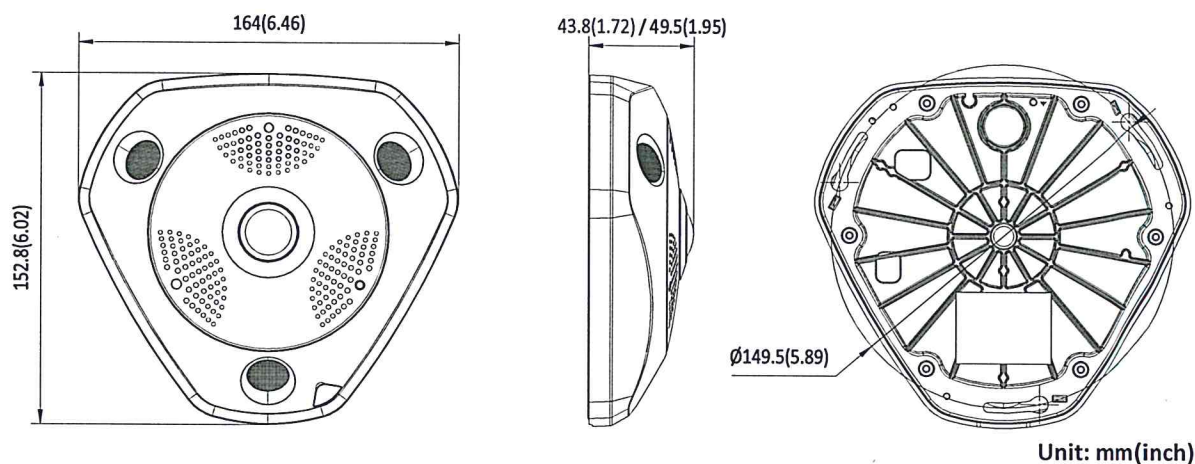

Accessories



DS-1280ZJ-DM25
Junction Box



DS-1281ZJ-DM25
Inclined Ceiling Mount



DS-1273ZJ-DM25
Wall Mount



DS-1271ZJ-DM25
Pendant Mount

Distributed by



DS-1283ZJ
Wall Mount (3-axis Adjustment)

HIKVISION

Headquarters

No.555 Qianmo Road, Binjiang District,
Hangzhou 310051, China
T +86-571-8807-5998
overseasbusiness@hikvision.com

Hikvision USA
T +1-909-895-0400
sales.usa@hikvision.com

Hikvision Italy
T +39-0438-6902
info.it@hikvision.com

Hikvision Singapore
T +65-6684-4718
sg@hikvision.com

Hikvision Africa
T +27 1101 0351 172
sale.africa@hikvision.com

Hikvision Europe
T +31-23-55-42-770
info.eu@hikvision.com

Hikvision France
T +33 01-85-330-450
info.fr@hikvision.com

Hikvision Oceania
T +61-2-8599-4233
salesau@hikvision.com

Hikvision Hong Kong
T +852-2151-1761

Hikvision Middle East
T +971-4-8816086
salesme@hikvision.com

Hikvision Spain
T +34-91-737-16-55
info.es@hikvision.com

Hikvision Canada
T +1-909-895-0400
sales.usa@hikvision.com

Hikvision Russia
T +7-495-669-67-99
saleru@hikvision.com

Hikvision Poland
T +48-22-460-01-50
poland@hikvision.com

Hikvision Korea
T +82-31-731-8841
sales.korea@hikvision.com

Hikvision India
T +91-22-28469900
sales@pramahikvision.com

Hikvision UK
T +01628-902140
support.uk@hikvision.com

Hikvision Brazil
T +55 11 3318-0050
Latam.support@hikvision.com

12 Megapixels

SurroundVideo® WDR IP Megapixel Dome Cameras

H.264 All-in-One 180° and 360° Panoramic WDR True Day/Night Indoor/Outdoor Dome IP Cameras

Camera Models

12MP Panoramic 180°	12MP Panoramic 360°
AV12186DN	AV12366DN

The H.264 12MP SurroundVideo® WDR is the industry's first wide dynamic range panoramic camera. The new SurroundVideo® WDR is an all-in-one solution with a dynamic range of up to 100dB at full resolution, has a dual encoder (H.264 and MJPEG), an impact-resistant dome, and is 50% smaller than previous SurroundVideo® models. A SurroundVideo® camera can replace multiple fixed or PTZ cameras by recording the entire panoramic field of view with the ability to zoom into multiple regions of interest—a return on investment that's easily measured.



180° Panoramic WDR



360° Panoramic WDR

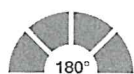

180° Panoramic

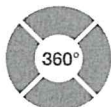

360° Panoramic

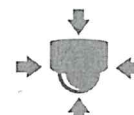

Wide Dynamic Range

All-in-One Dome Solution
with Integrated LensImpact / Weather Resistant
IK-10 and IP66 Rated

Pixel Binning Mode

True Day/Night
with IR Cut FilterDual Encoder
H.264/MJPEG

Features:

- Industry's First 12MP WDR Panoramic Megapixel Cameras
- True WDR up to 100dB at Full Resolution: See Clearly in Shaded and Bright Light Conditions Simultaneously
- Forensic Zooming – Zoom Live or After the Event While Recording Full Field-of-View in HD – Replace PTZ Devices
- Binning Mode for Strong Low Light Performance
- Bit Rate Control and Multi-Streaming
- True Day/Night Functionality with Electro-Mechanical IR Cut Filter
- Outdoor Rated IP66 and IK-10 Impact-Resistant Housing
- Total PoE Solution (No External Power Required)
- PoE and Auxiliary Power: 12–48V DC/24V AC
- Easily Adjustable 2-Axis Camera Gimbal with 360° Pan and 90° Tilt
- +/- 5° Electrical Vertical Alignment to Locate Each Sensor Position (180° Series)
- +/- 7° Mechanical Tilt Adjustment to Locate Each Sensor Angle (360° Series)
- Complete Mounting Options
- Dual Encoder H.264/MJPEG
- Privacy Mask, Motion Detection, Flexible Cropping, Bit Rate Control and Multi-Streaming
- Fast Frame Rates 5.2fps @ 12MP
- Reduced Overall System Cost

Camera Imaging

Model	AV12186DN		AV12366DN	
Image Sensor	4 x 3MP CMOS WDR		4 x 3MP CMOS WDR	
Optical Format	1/3.2" Progressive Scan		1/3.2" Progressive Scan	
Pixel Pitch	2.2µm		2.2µm	
Minimum Illumination	Color	0.5 Lux @ F2.0	Color	0.5 Lux @ F2.0
	Color Binning	0.25 Lux @ F2.0	Color Binning	0.25 Lux @ F2.0
	True Day/Night	0 Lux, IR sensitive	True Day/Night	0 Lux, IR sensitive
Full Field of View (FOV) Resolution	Total	8192 H x 1536 V	Total	8192 H x 1536 V
	Per Sensor	2048 H x 1536 V	Per Sensor	2048 H x 1536 V
1/4 Resolution	Total	4096 H x 768 V	Total	4096 H x 768 V
	Per Sensor	1024 H x 768 V	Per Sensor	1024 H x 768 V
Dynamic Range	Up to 100dB at Full Resolution		Up to 100dB at Full Resolution	
Lens	5.4mm, M12, F2.0, 1/3.2"		2.6mm, M12, F2.0, 1/2.5"	
Video Frame Rates	Max	5.2fps (8192 x 1536)	Max	5.2fps (8192 x 1536)
		16.7fps (4096 x 768)		16.7fps (4096 x 768)

Data Transmission

Compression Type	H.264 (MPEG-4, Part 10)/Motion JPEG 21 levels of quality	Electrical	Input/Output	General purpose opto-coupled
Network Protocols	RTSP, RTP/TCP, RTP/UDP, HTTP, DHCP, TFTP		Power Over Ethernet	PoE 802.3af, Class 3
Network Interface	100Base-T Ethernet		Auxiliary Power	12-48V DC and 24V AC
Multi-Streaming	8 non-identical streams (2 per sensor)		Max Power Consumption	14 Watts Max (Auxiliary Power)
		Mechanical	Casing	Die-cast aluminum chassis with 4" polycarbonate dome bubble

Programmability

Auto adjustment between WDR and LDR modes				IP66 weather proof standard
Binning Mode				Impact resistant, IK-10 rated
Privacy mask			Gimbal	Easily adjustable, 2-axis w/360° pan and 90° tilt
Flexible Cropping (resolution windowing down to 1x1 pixel for JPEG and 2x2 pixels for H.264)			Total Unit Dimensions	Unit Ø 5.5" (140mm) x 4.9" H (125mm)
+/-5° Digital Vertical Alignment to adjust images (AV12186DN)				Bubble Only Ø 4.0" (102mm) x 2.4" H (62mm)
On-camera real-time motion detection with up to 1024 detection zones (per sensor)			Weight	Unit 2.8lbs (1.27kg)
Auto multi-matrix white balance				Packaged 3.4lbs (1.54kg)
50/60Hz selectable flicker control				
Electronic pan, tilt, zoom (PTZ)				
Programmable shutter speed to help control motion blur				
MoonLight™ Mode: extended exposure and proprietary noise cancellation				
Programmable resolution, brightness, saturation, gamma, sharpness, tint				
Simultaneous delivery of full field-of-view and zoomed images				
Bandwidth and storage savings by running at 1/4 resolution				
Bit rate and bandwidth limit control				

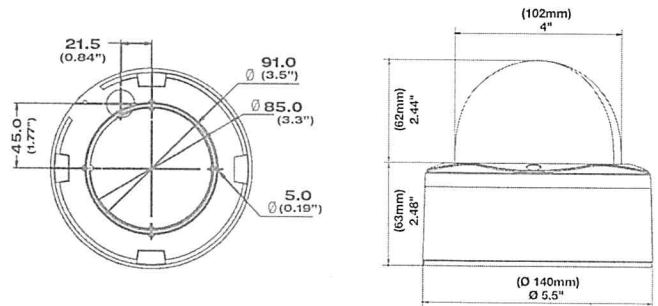

Compliance

Industry Standard	ONVIF Profile S Conformant
Listings	UL (CB)
FCC Compliance	47 CFR 15 Class A
Environmental	RoHS, REACH, WEEE

Accessories

MD-WMT2	Wall Mount w/1.5" NPT
SV-EBA	Electrical Box Adapter for MD-WMT2
MD-CAP	Wall Mount Cap Only w/1.5" NPT
MD-CMT	Pendant Mount
MD-FMA	Flush Mount
MD-CRMA	Corner Mount Adapter
MD-PMA	Pole Mount Adapter
MD-EBA	Electrical Box Adapter
SV-JBA	Junction Box Adapter

Environmental

Protection Ratings	IP66 water/dust protection rating IK-10 impact-resistant polycarbonate dome
Operating temperature	-40°C (-40°F) to +50°C (122°F)
Humidity	0% to 90% (non-condensing)
Stable image temperature	0°C (32°F) to +50°C (122°F)
Storage temperature	-40°C (-40°F) to +60°C (140°F)

SurroundVideo® Omni IP Megapixel Cameras

12MP WDR or 20MP H.264 All-in-One Omni-Directional User-Configurable Multi-Sensor
True Day/Night Indoor/Outdoor Dome IP Cameras

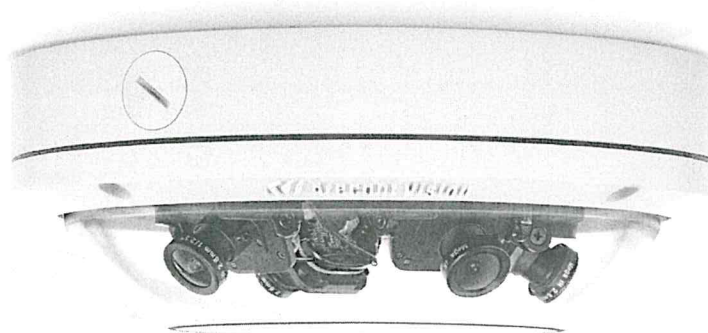

Delivering revolutionary flexibility, Arecont Vision SurroundVideo Omni multi-sensor, multi-megapixel cameras provide ample resolution to zoom-in for details in live and recorded video. With multiple imagers, each with a choice of an IR corrected lens, one SurroundVideo Omni can replace 4 standard cameras, requiring just a single installation with only one ethernet cable.

A unique track design allows four individual sensor gimbals to be independently placed in nearly any configuration. Popular uses of SurroundVideo Omni IP66 rated / IK-10 impact-resistant cameras are

to cover the intersection of hallways or to provide a 270° view at the corner of a building.

SurroundVideo Omni cameras are available in total resolutions of 12 megapixels (MP) or 20 megapixels. Optional lenses can be selected from a choice of 2.1, 2.8, 4, 6, 8, 12 and 16mm. Wide Dynamic Range (WDR) that delivers up to 100dB at full resolution is available in the 12MP model. H.264 compression reduces bandwidth and storage requirements, while delivering full frame rates and resolution, without sacrificing image quality.

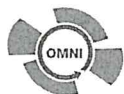

Omni-Directional Track with
4 Customizable Sensors

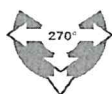

270° FOV
Capable



Wide Dynamic Range
on 12MP Models



True Day/Night
with IR Cut Filter



Pixel Binning Mode



Dual Encoder
H.264/MJPEG



Ultra Low Profile
Design



Impact / Weather Resistant
IK-10 and IP66 Rated

Series Features

- 12MP WDR and 20MP Models
- Up to 4 Individual Camera Gimbals can be Independently Placed in Any Orientation Around a 360° Track with Extra Positions for Looking Straight Down
- Multiple Lens Options in a Single Camera Housing from 2.1mm up to 16mm
- True Day/Night Functionality with Mechanical IR Cut Filter
- Forensic Zooming – Zoom Live or After the Event While Recording Full Field-of-View in HD – Replace PTZ Devices
- Privacy Mask, Motion Detection, Flexible Cropping, Bit Rate Control and Multi-Streaming
- Dual Encoder H.264/MJPEG
- PoE and Auxiliary Power: 12–48V DC/24V AC
- Ultra Discrete, Low-Profile Housing
- Outdoor Rated IP66 and IK-10 Impact-Resistant Housing
- Complete Mounting Options
- True WDR up to 100dB at Full Resolution: See Clearly in Shaded and Bright Light Conditions Simultaneously
- Binning Mode for Strong Low Light Performance

SurroundVideo® Omni IP Megapixel Cameras

Specifications

Camera Specifications

Model		AV12176DN		AV20175DN	
Image Sensor		4 x 3MP CMOS		4 x 5MP CMOS	
Optical Format		1/3.2"		1/2.5"	
Pixel Pitch		2.2µm		2.2µm	
Minimum Illumination	Color (Day Mode)	0.5 Lux		0.3 Lux	
	Color Binning (Day Mode)	0.15 Lux		0.15 Lux	
	B/W (Night Mode)	0 Lux, IR sensitive		0 Lux, IR sensitive	
Full FOV Resolution		Total	8192 H x 1536 V	Total	10240 H x 1920 V
		Per Sensor	2048 H x 1536 V	Per Sensor	2560 H x 1920 V
1/4 Resolution		Total	4096 H x 768 V	Total	5120 H x 960 V
		Per Sensor	1024 H x 768 V	Per Sensor	1280 H x 960 V
Dynamic Range		Up to 100dB at Full Resolution		70.1dB	
Frame Rates	At Max Resolution	5.2fps (8192x1536)		3.5fps (10240x1920)	
	1/4 Resolution	16.7fps (4096x768)		11fps (5120x960)	
	Binning Mode	17fps (4096x768)		13fps (5120x960)	
Lens	2.8mm Lens Option (-28 Models)	2.8mm, F1.8, H-FOV = 89°		2.8mm, F1.8, H-FOV = 113°	
	8mm Lens Option (-08 Models)	8mm, F1.6, H-FOV = 33°		8mm, F1.6, H-FOV = 40°	

Programmability

Optics	Pixel Binning Mode
Picture-in-Picture	Simultaneous delivery of full field-of-view and zoomed images
Programmable Shutter Speed	Controls motion blur, 1ms-500ms
Motion Detection	Real-time, 1024 detection zones
Privacy Masking	Unlimited
MoonLight™ Mode	Extended exposure and noise cancellation
Flexible Cropping	Resolution windowing down to 1x1 pixel for JPEG and 2x2 pixels for H.264
Backlight Compensation	Auto multi-matrix white balance
Flicker Control	50/60Hz selectable
Wide Dynamic Range	Auto switch control adjustment between WDR and LDR modes (WDR models)
Efficiency	Bit rate and bandwidth limitation control Bandwidth and storage savings by running at 1/4 resolution
Sharpness	Selectable enhancement level
Miscellaneous	Programmable resolution, brightness, saturation, gamma, tint Simultaneous delivery of full field-of-view and zoomed images Electronic pan, tilt, zoom (PTZ) Auto Exposure (AE) and Gain Control (AGC) > 120dB Programmable shutter speed to help control motion blur

Data Transmission

Compression Type	H.264 (MPEG-4, Part 10)/Motion JPEG 21 levels of quality
Network Protocols	RTSP, RTP/TCP, RTP/UDP, HTTP, DHCP, TFTP
Network Interface	100Base-T Ethernet
Multi-Streaming	8 non-identical streams

Compliance

Industry Standard	ONVIF Profile S Conformant
Listings	UL (CB)
FCC Compliance	47 CFR 15 Class A
Environmental	RoHS, REACH, WEEE
Markings	(CE) EN 55022:2010 Class A, EN 55024:2010, EN 61000-3-2:2006+A1:2009+A2:2009, EN61000-3-3: 2008, EN60950-1:2006+A11:2009+A1:2010+A12:2011, (UL) IEC 60950-1 (ed. 2) and IEC 60950-22 (ed. 1)
CoO	Made in the USA

Environmental

Operating temperature	-40°C (-40°F) to +50°C (122°F)
Humidity	0% to 90% (non-condensing)
Storage temperature	-40°C (-40°F) to +60°C (140°F)

SurroundVideo® Omni IP Megapixel Cameras

Specifications

Electrical

Alarm Input/Output	1 input/1 output
Power Over Ethernet	PoE 802.3af, Class 3
Auxiliary Power	12-48V DC, 24V AC
Maximum Power Consumption	14 Watts Max (Aux)

Mechanical

Casing	Die-cast aluminum chassis with polycarbonate dome bubble
	IP66 weather proof standard
	Impact resistant, IK-10 rated
Gimbal	Easily adjustable, 2-axis w/360° pan and 90° tilt
Dimensions	Unit Ø 7.7" (196mm) x 3.1" H (78.5mm)
(See Dimensions)	Bubble Only Ø 6.7" (169.2mm) x 1.3" H (33.4mm)
	Packaged 8" W (203mm) x 8" L (203mm) x 4" H (102mm)
Weight	Unit 2.8lbs (1.27kg)
	Packaged 3.4lbs (1.54kg)

Dimensions

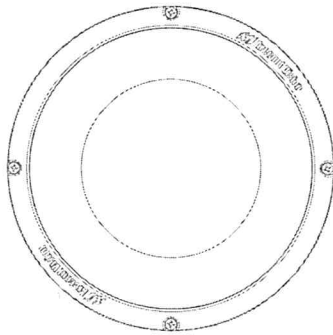
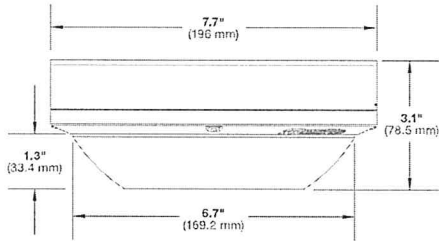

SO-FMA

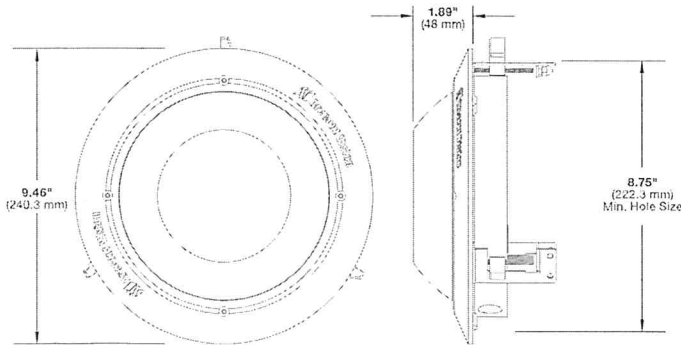

Accessories (Sold Separately)

AV-CRMA	Corner Mount Adapter
AV-EBA	Electrical Box Adapter
AV-PMA	Pole Mount Adapter
AV-PMJB	Pendant Mount Bracket with Junction Box
AV-WMJB	Wall Mount Bracket with Junction Box
SO-CAP	Cap for SurroundVideo® Omni
SO-FMA	Flush Mount Adapter

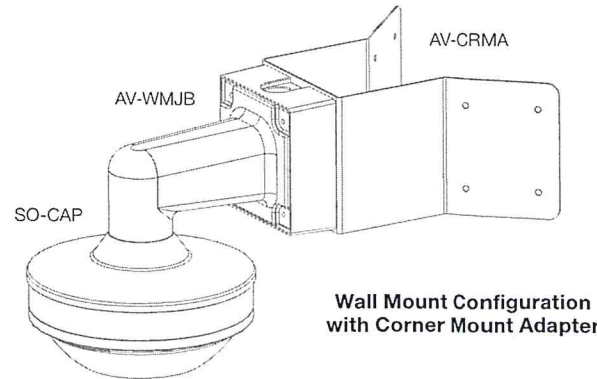
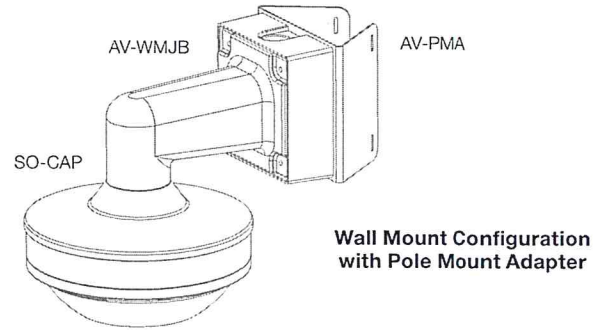
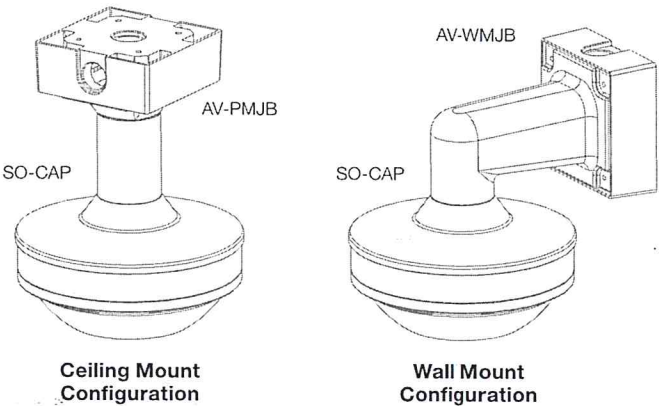

Ordering Information

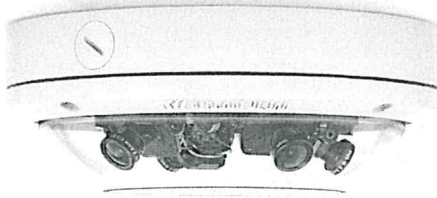

Options

-NL	No Lenses (User Configurable and Ordered Separately)
-28	Configured with 2.8mm Lenses*
-08	Configured with 8mm Lenses**

* Good option for a 270° Corner Mount configuration

** Good configuration option for a hallway intersection

Lens Options

Manual Fixed Focal		
MPM2.1 (2.1mm) Ordered Separately	3MP	
MPM2.8A (2.8mm) Standard (-28 Models)	3MP	5MP
MPM4.0A (4mm) Ordered Separately	3MP	5MP
MPM6.0 (6mm) Ordered Separately	3MP	5MP
MPM8.0 (8mm) Standard (-08 Models)	3MP	5MP
MPM12.0A (12mm) Ordered Separately	3MP	5MP
MPM16.0 (16mm) Ordered Separately	3MP	5MP

Model Specific Features

Model	Resolution	Frame Rate	Features	
AV12176DN	12MP	5.2fps	WDR	Binning
AV20175DN	20MP	3.5fps	-	Binning

Model Numbers

12MP	AV12176DN-NL	WDR
	AV12176DN-28	WDR
	AV12176DN-08	WDR
20MP	AV20175DN-NL	
	AV20175DN-28	
	AV20175DN-08	

Create Your Model (Example: AV12176DN-28)

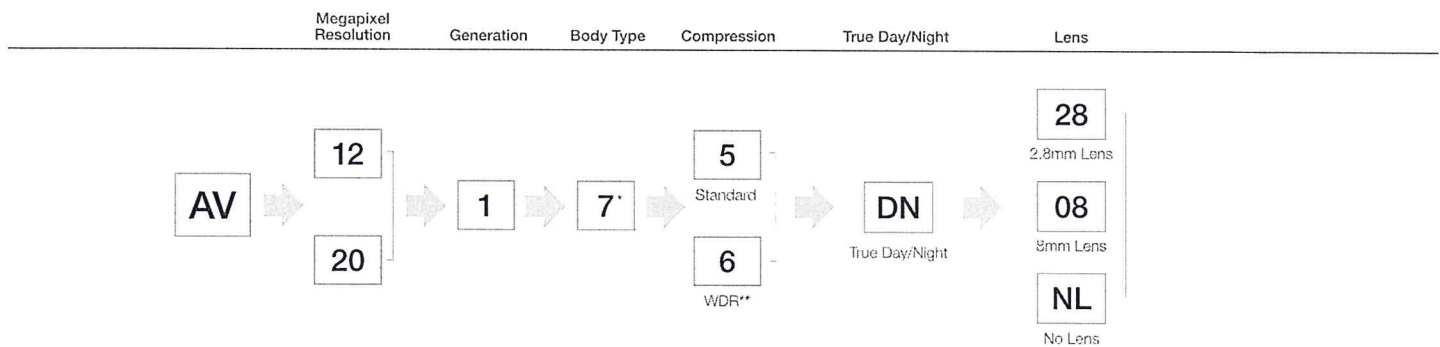

* "7" represents SurroundVideo Omni product line

** WDR for AV12176 models only